

W. CENTURY BLVD

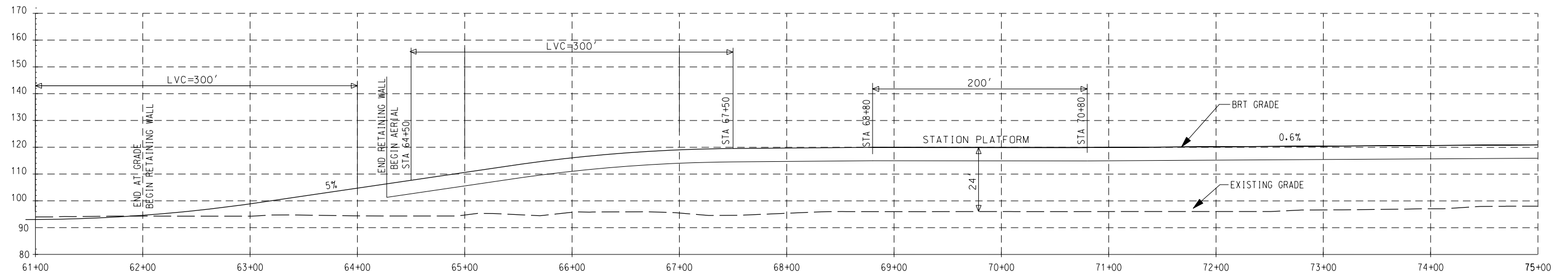

NOTES:

[X] INDICATES ITEM NUMBER ON RIGHTS-OF-WAY INFORMATION SHEET, DRWG C-250.

LEGEND

← BRT IN EXCLUSIVE BUSWAY
 ■ BRT STATION AREA

THE PREPARATION OF THIS DRAWING HAS BEEN FINANCED IN PART THROUGH A GRANT FROM THE U.S. DEPARTMENT OF TRANSPORTATION, FEDERAL TRANSIT ADMINISTRATION (FTA), UNDER THE FEDERAL TRANSIT ACT OF 1964, AS AMENDED, AND IN PART BY THE TAXES OF THE CITIZENS OF LOS ANGELES COUNTY AND OF THE STATE OF CALIFORNIA.

REV	DATE	BY	APP	REG NO	EXPIRES	SEAL HOLDER	DESCRIPTION

DESIGNED BY	
DRAWN BY	
CHECKED BY	
IN CHARGE	
DATE	



LOS ANGELES COUNTY METROPOLITAN TRANSPORTATION AUTHORITY
 Crenshaw Transit Corridor Project
Parsons Brinckerhoff
 In Association with
 Jenkins Gales Martinez, Inc.

PROJECT MANAGER

BUS RAPID TRANSIT
 PLAN AND PROFILE
 STA 61+00 TO STA 75+00

CONTRACT NO PS-4330-1968	
DRAWING NO C-105	REV 0
SCALE HORIZ: 1" = 100' VERT: 1" = 40'	
SHEET NO	

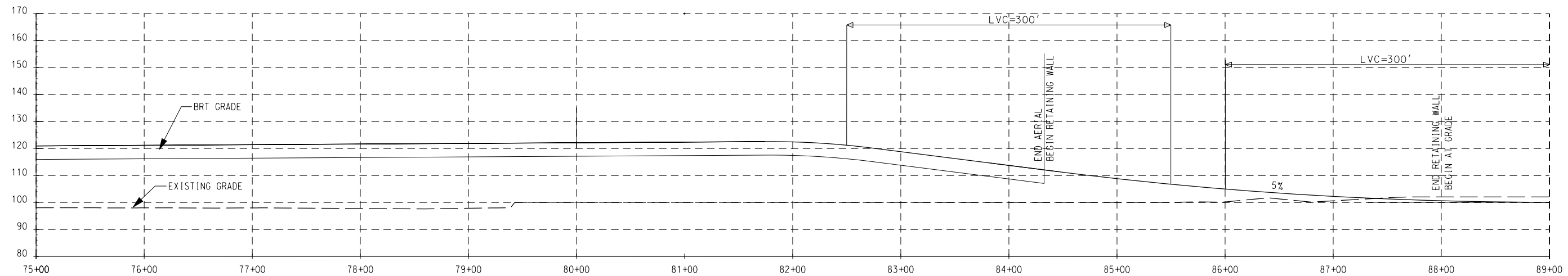
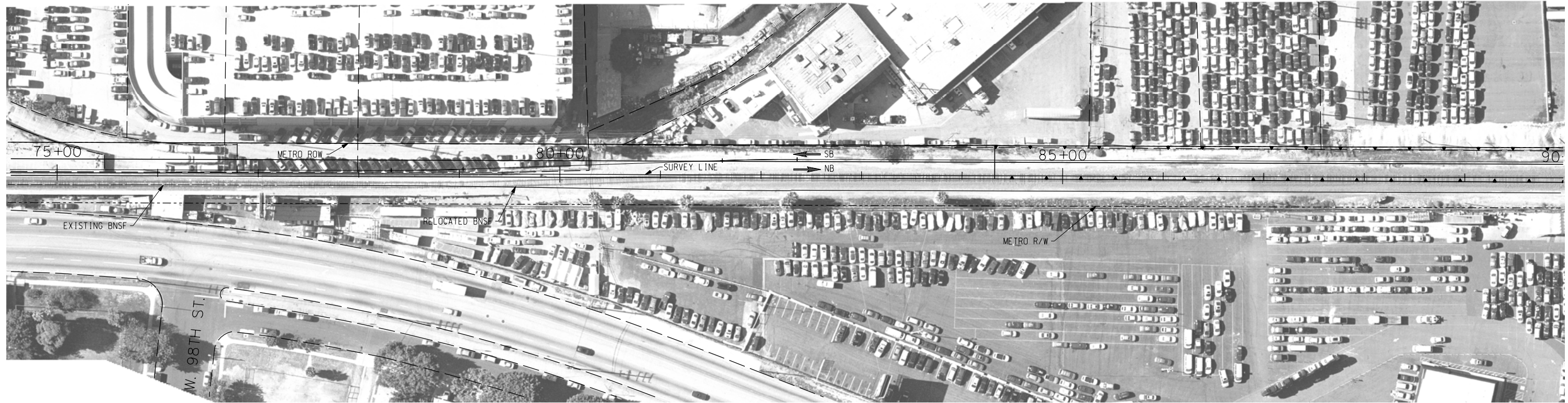
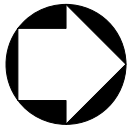

NOTES:

[X] INDICATES ITEM NUMBER ON RIGHTS-OF-WAY INFORMATION SHEET, DRWG C-250.

LEGEND

← BRT IN EXCLUSIVE BUSWAY

THE PREPARATION OF THIS DRAWING HAS BEEN FINANCED IN PART THROUGH A GRANT FROM THE U.S. DEPARTMENT OF TRANSPORTATION, FEDERAL TRANSIT ADMINISTRATION (FTA), UNDER THE FEDERAL TRANSIT ACT OF 1964, AS AMENDED, AND IN PART BY THE TAXES OF THE CITIZENS OF LOS ANGELES COUNTY AND OF THE STATE OF CALIFORNIA.

REV	DATE	BY	APP	REG NO	EXPIRES	SEAL HOLDER	DESCRIPTION

DESIGNED BY	
DRAWN BY	
CHECKED BY	
IN CHARGE	
DATE	

M Metro LOS ANGELES COUNTY METROPOLITAN TRANSPORTATION AUTHORITY
Crenshaw Transit Corridor Project

PB 100 YEARS Parsons Brinckerhoff
In Association with Jenkins Gales Martinez, Inc.

PROJECT MANAGER

BUS RAPID TRANSIT

PLAN AND PROFILE
STA 75+00 TO STA 89+00

CONTRACT NO. PS-4330-1968
DRAWING NO. C-106 REV 0
SCALE HORIZ: 1" = 100'
VERT: 1" = 40'
SHEET NO.

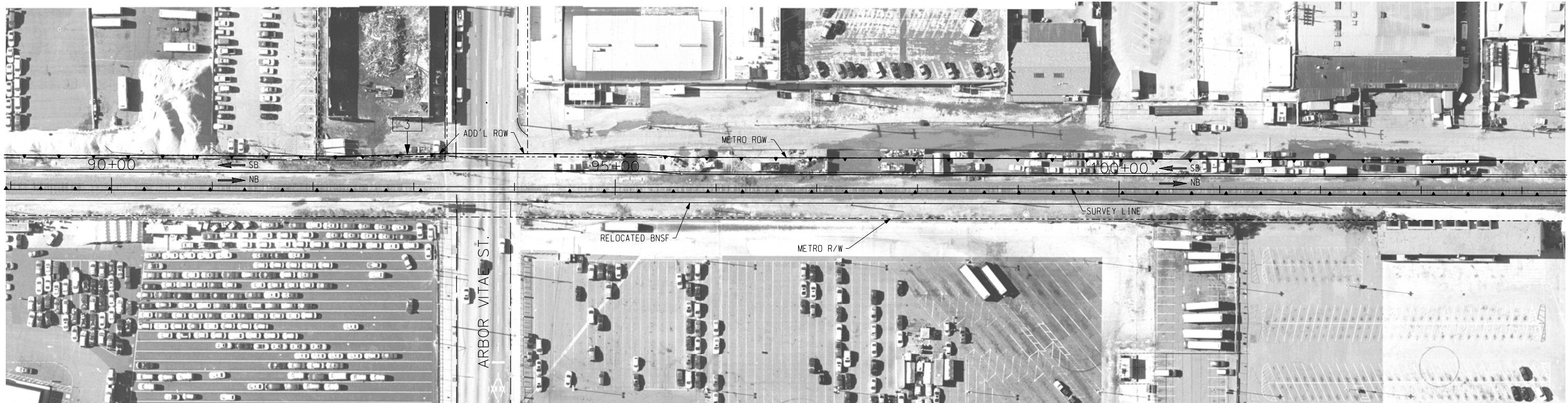
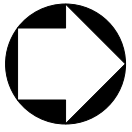

NOTES:

☒ INDICATES ITEM NUMBER ON RIGHTS-OF-WAY INFORMATION SHEET, DRWG C-250.

LEGEND

↔ BRT IN EXCLUSIVE BUSWAY

THE PREPARATION OF THIS DRAWING HAS BEEN FINANCED IN PART THROUGH A GRANT FROM THE U.S. DEPARTMENT OF TRANSPORTATION, FEDERAL TRANSIT ADMINISTRATION (FTA), UNDER THE FEDERAL TRANSIT ACT OF 1964, AS AMENDED, AND IN PART BY THE TAXES OF THE CITIZENS OF LOS ANGELES COUNTY AND OF THE STATE OF CALIFORNIA.

REV	DATE	BY	APP	REG NO	EXPIRES	SEAL HOLDER	DESCRIPTION

DESIGNED BY	
DRAWN BY	
CHECKED BY	
IN CHARGE	
DATE	

M Metro **LOS ANGELES COUNTY METROPOLITAN TRANSPORTATION AUTHORITY**
Crenshaw Transit Corridor Project

PB Parsons Brinckerhoff
 In Association with **Jenkins Gales Martinez, Inc.**

PROJECT MANAGER

BUS RAPID TRANSIT

PLAN
 STA 89+00 TO STA 104+00

CONTRACT NO	PS-4330-1968
DRAWING NO	C-107
SCALE	1"=100'
SHEET NO	

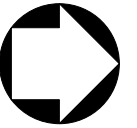

NOTES:

[X] INDICATES ITEM NUMBER ON RIGHTS-OF-WAY INFORMATION SHEET, DRWG C-250.

LEGEND

- BRT IN EXCLUSIVE BUSWAY
- BRT STATION AREA

THE PREPARATION OF THIS DRAWING HAS BEEN FINANCED IN PART THROUGH A GRANT FROM THE U.S. DEPARTMENT OF TRANSPORTATION, FEDERAL TRANSIT ADMINISTRATION (FTA), UNDER THE FEDERAL TRANSIT ACT OF 1964, AS AMENDED, AND IN PART BY THE TAXES OF THE CITIZENS OF LOS ANGELES COUNTY AND OF THE STATE OF CALIFORNIA.

REV	DATE	BY	APP	REG NO	EXPIRES	SEAL HOLDER	DESCRIPTION

DESIGNED BY
DRAWN BY
CHECKED BY
IN CHARGE
DATE



LOS ANGELES COUNTY METROPOLITAN TRANSPORTATION AUTHORITY
Crenshaw Transit Corridor Project

Parsons Brinckerhoff
In Association with
Jenkins Gales Martinez, Inc.

PROJECT MANAGER

BUS RAPID TRANSIT

PLAN
STA 104+00 TO 115+00

CONTRACT NO	PS-4330-1968
DRAWING NO	C-108
SCALE	1"=100'
SHEET NO	

REV 0

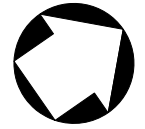

NOTES:

☒ INDICATES ITEM NUMBER ON RIGHTS-OF-WAY INFORMATION SHEET, DRWG C-250.

LEGEND

- BRT IN EXCLUSIVE BUSWAY
- BRT STATION AREA

THE PREPARATION OF THIS DRAWING HAS BEEN FINANCED IN PART THROUGH A GRANT FROM THE U.S. DEPARTMENT OF TRANSPORTATION, FEDERAL TRANSIT ADMINISTRATION (FTA), UNDER THE FEDERAL TRANSIT ACT OF 1964, AS AMENDED, AND IN PART BY THE TAXES OF THE CITIZENS OF LOS ANGELES COUNTY AND OF THE STATE OF CALIFORNIA.

REV	DATE	BY	APP	REG NO	EXPIRES	SEAL HOLDER	DESCRIPTION

DESIGNED BY
DRAWN BY
CHECKED BY
IN CHARGE
DATE

M Metro **LOS ANGELES COUNTY METROPOLITAN TRANSPORTATION AUTHORITY**
Crenshaw Transit Corridor Project

PB Parsons Brinckerhoff
 In Association with Jenkins Gales Martinez, Inc.

PROJECT MANAGER

BUS RAPID TRANSIT

PLAN
 STA 115+00 TO 127+00

CONTRACT NO	PS-4330-1968
DRAWING NO	C-109
SCALE	1"=100'
SHEET NO	0