

THE PREPARATION OF THIS DRAWING HAS BEEN FINANCED IN PART THROUGH A GRANT FROM THE U.S. DEPARTMENT OF TRANSPORTATION, FEDERAL TRANSIT ADMINISTRATION (FTA), UNDER THE FEDERAL TRANSIT ACT OF 1964, AS AMENDED, AND IN PART BY THE TAXES OF THE CITIZENS OF LOS ANGELES COUNTY AND OF THE STATE OF CALIFORNIA.

REV	DATE	BY	APP	REG NO	EXPIRES	SEAL HOLDER	DESCRIPTION

DESIGNED BY	
DRAWN BY	
CHECKED BY	
IN CHARGE	
DATE	

**M Metro** LOS ANGELES COUNTY METROPOLITAN TRANSPORTATION AUTHORITY  
**Crenshaw Transit Corridor Project**

**PB Parsons Brinckerhoff**  
 In Association with Jenkins Gales Martinez, Inc.

PROJECT MANAGER

LIGHT RAIL TRANSIT

PLAN & PROFILE  
 STA 294+00 TO STA 307+00

CONTRACT NO	PS-4330-1968
DRAWING NO	C-423
SCALE	HORIZ: 1" = 100' VERT: 1" = 40'
SHEET NO	0

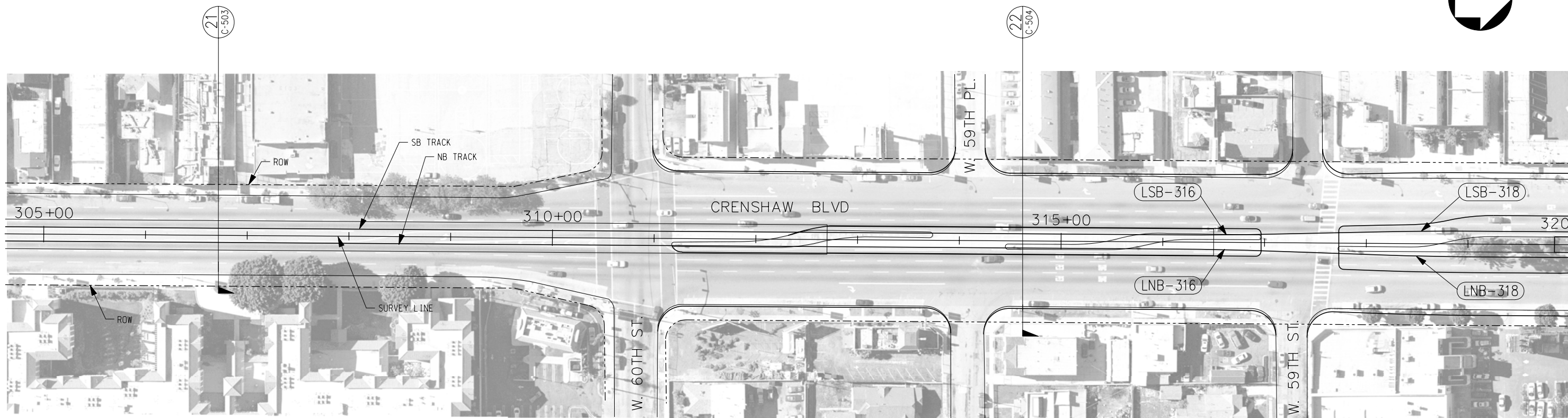
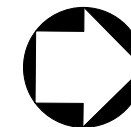

- NOTES:
1. Design Option For Cut and Cover LRT Alignment Between Victoria Ave And 60th Street See Drawings C-620 thru C-625
  2. Length of Vertical Curves Do Not Meet Design Criteria Due To Existing Street Gradient And Shall Be Reviewed Further In PE Phase

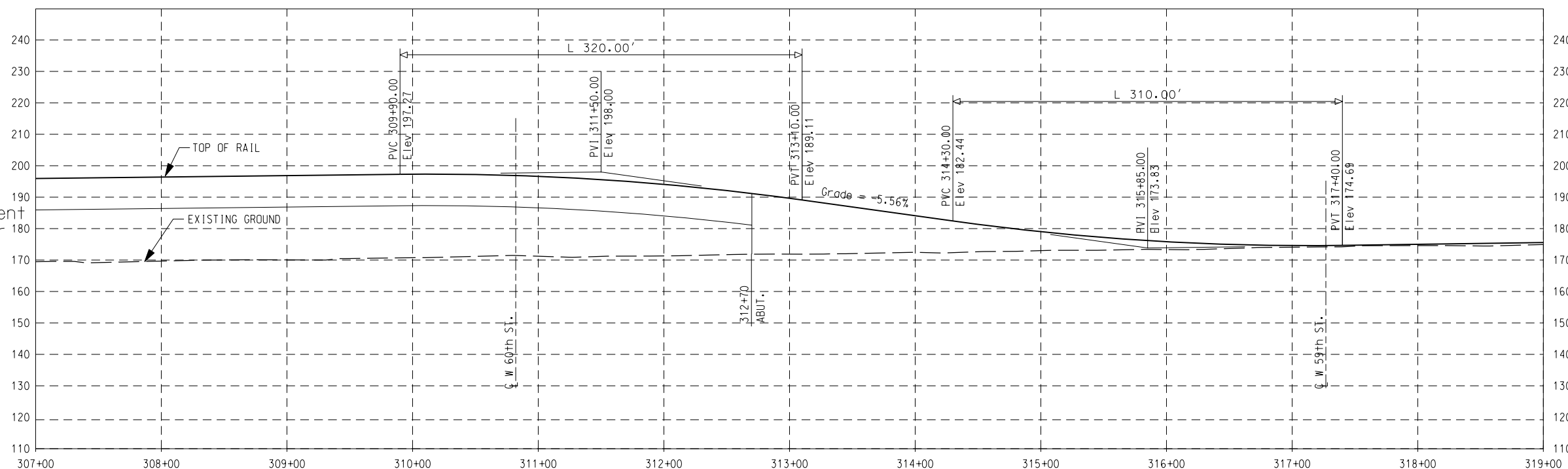

THE PREPARATION OF THIS DRAWING HAS BEEN FINANCED IN PART THROUGH A GRANT FROM THE U.S. DEPARTMENT OF TRANSPORTATION, FEDERAL TRANSIT ADMINISTRATION (FTA), UNDER THE FEDERAL TRANSIT ACT OF 1964, AS AMENDED, AND IN PART BY THE TAXES OF THE CITIZENS OF LOS ANGELES COUNTY AND OF THE STATE OF CALIFORNIA.

REV	DATE	BY	APP	REG NO	EXPIRES	SEAL HOLDER	DESCRIPTION

DESIGNED BY	
DRAWN BY	
CHECKED BY	
IN CHARGE	
DATE	



**LOS ANGELES COUNTY METROPOLITAN TRANSPORTATION AUTHORITY**  
Crenshaw Transit Corridor Project

**Parsons Brinckerhoff**  
In Association with  
Jenkins Gales Martinez, Inc.

PROJECT MANAGER

LIGHT RAIL TRANSIT  
PLAN & PROFILE  
STA 307+00 TO STA 319+00

CONTRACT NO	PS-4330-1968
DRAWING NO	C-424
SCALE	HORIZ: 1" = 100' VERT: 1" = 40'
SHEET NO	0

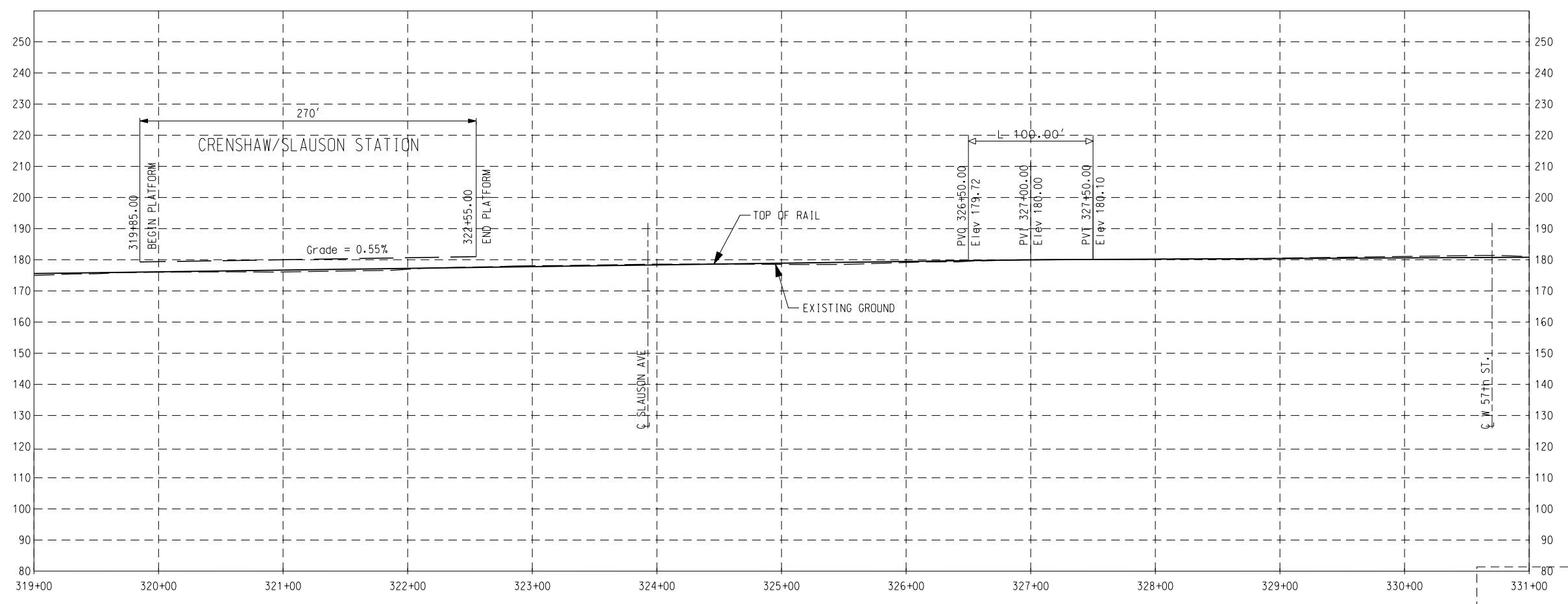
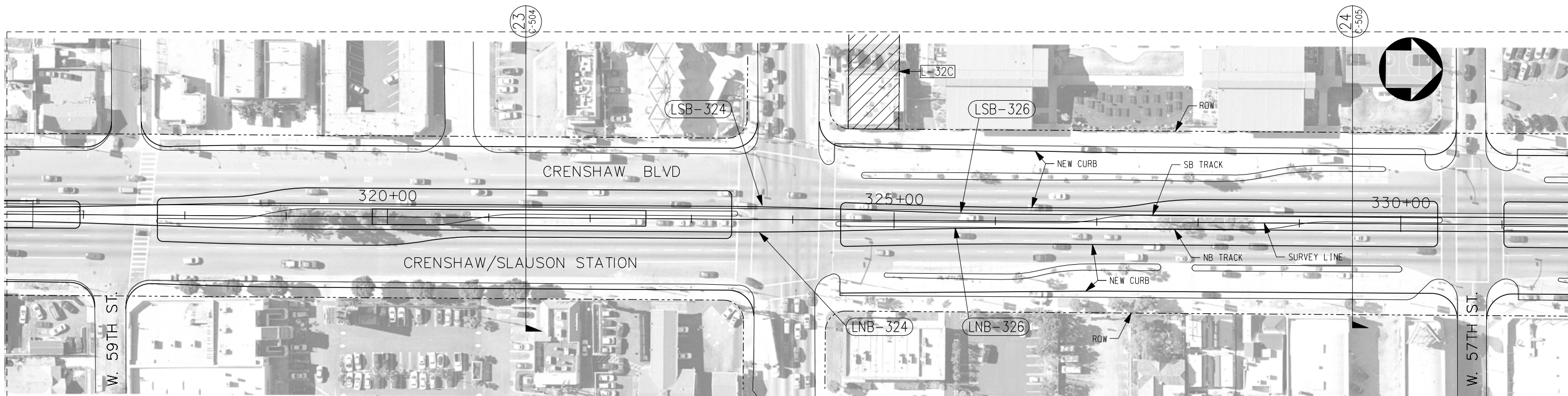

THE PREPARATION OF THIS DRAWING HAS BEEN FINANCED IN PART THROUGH A GRANT FROM THE U.S. DEPARTMENT OF TRANSPORTATION, FEDERAL TRANSIT ADMINISTRATION (FTA), UNDER THE FEDERAL TRANSIT ACT OF 1964, AS AMENDED, AND IN PART BY THE TAXES OF THE CITIZENS OF LOS ANGELES COUNTY AND OF THE STATE OF CALIFORNIA.

REV	DATE	BY	APP	REG NO	EXPIRES	SEAL HOLDER	DESCRIPTION

DESIGNED BY	
DRAWN BY	
CHECKED BY	
IN CHARGE	
DATE	

**M Metro** LOS ANGELES COUNTY METROPOLITAN TRANSPORTATION AUTHORITY  
**Crenshaw Transit Corridor Project**

**PB Parsons Brinckerhoff**  
 In Association with Jenkins Gales Martinez, Inc.

PROJECT MANAGER

LIGHT RAIL TRANSIT  
 PLAN & PROFILE  
 STA 319+00 TO STA 331+00

CONTRACT NO	PS-4330-1968
DRAWING NO	C-425
SCALE	HORIZ: 1" = 100' VERT: 1" = 40'
SHEET NO	0

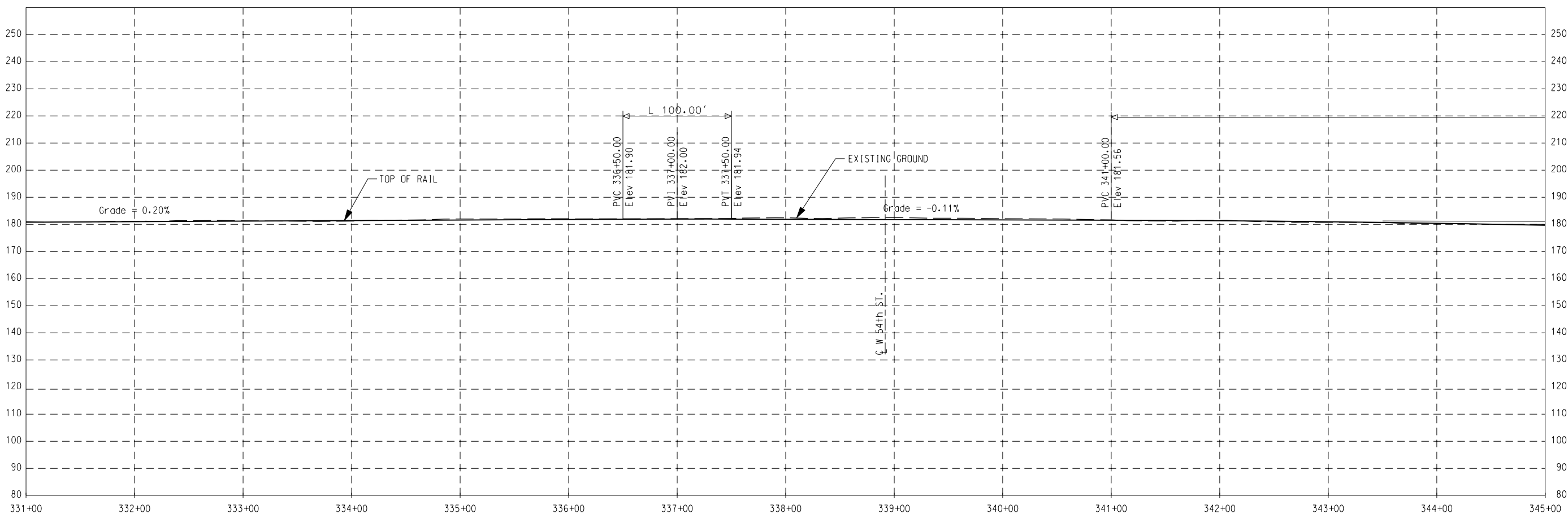
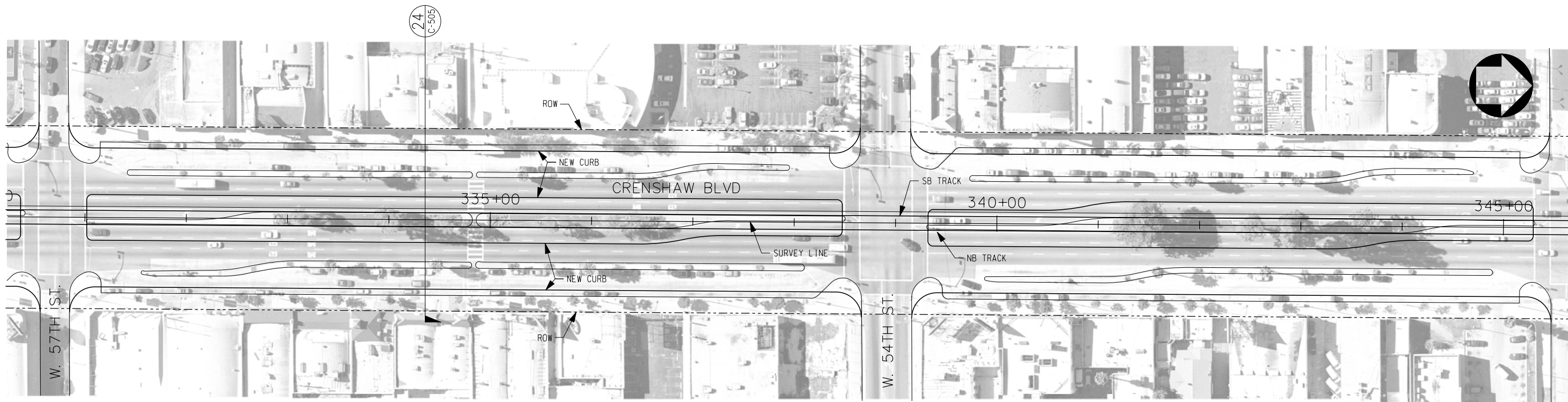

THE PREPARATION OF THIS DRAWING HAS BEEN FINANCED IN PART THROUGH A GRANT FROM THE U.S. DEPARTMENT OF TRANSPORTATION, FEDERAL TRANSIT ADMINISTRATION (FTA), UNDER THE FEDERAL TRANSIT ACT OF 1964, AS AMENDED, AND IN PART BY THE TAXES OF THE CITIZENS OF LOS ANGELES COUNTY AND OF THE STATE OF CALIFORNIA.

REV	DATE	BY	APP	REG NO	EXPIRES	SEAL HOLDER	DESCRIPTION

DESIGNED BY	
DRAWN BY	
CHECKED BY	
IN CHARGE	
DATE	

**M Metro**  
**LOS ANGELES COUNTY METROPOLITAN TRANSPORTATION AUTHORITY**  
**Crenshaw Transit Corridor Project**

**PB Parsons Brinckerhoff**  
 In Association with  
 Jenkins Gales Martinez, Inc.

PROJECT MANAGER

**LIGHT RAIL TRANSIT**

PLAN & PROFILE  
 STA 331+00 TO STA 345+00

CONTRACT NO  
**PS-4330-1968**

DRAWING NO  
**C-426**

SCALE  
 HORIZ: 1" = 100'  
 VERT: 1" = 40'

SHEET NO  
**0**

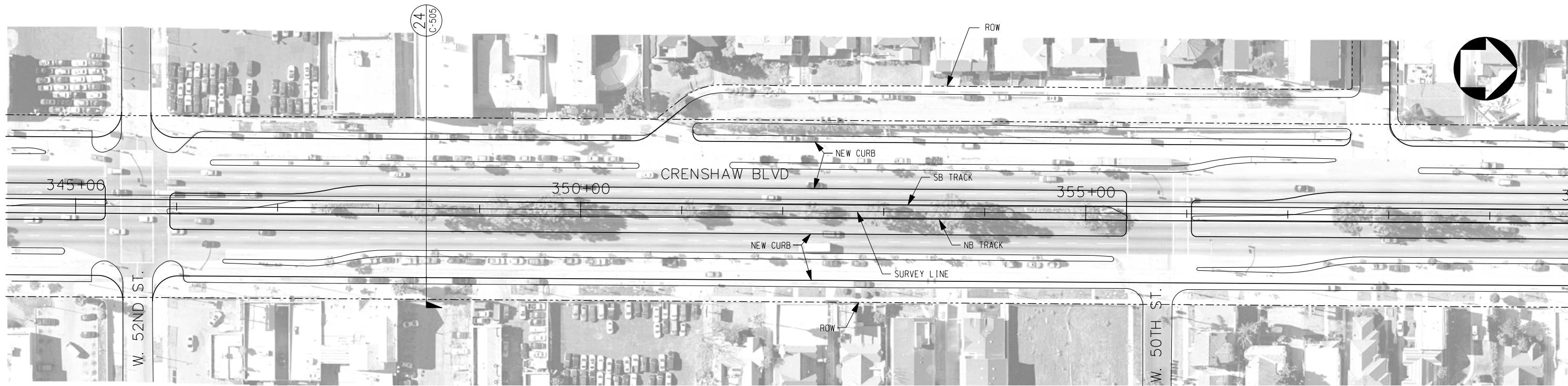

THE PREPARATION OF THIS DRAWING HAS BEEN FINANCED IN PART THROUGH A GRANT FROM THE U.S. DEPARTMENT OF TRANSPORTATION, FEDERAL TRANSIT ADMINISTRATION (FTA), UNDER THE FEDERAL TRANSIT ACT OF 1964, AS AMENDED, AND IN PART BY THE TAXES OF THE CITIZENS OF LOS ANGELES COUNTY AND OF THE STATE OF CALIFORNIA.

REV	DATE	BY	APP	REG NO	EXPIRES	SEAL HOLDER	DESCRIPTION

DESIGNED BY	
DRAWN BY	
CHECKED BY	
IN CHARGE	
DATE	

**LOS ANGELES COUNTY METROPOLITAN TRANSPORTATION AUTHORITY**  
 Crenshaw Transit Corridor Project

**Parsons Brinckerhoff**  
 In Association with  
 Jenkins Gales Martinez, Inc.

PROJECT MANAGER

**LIGHT RAIL TRANSIT**  
 PLAN & PROFILE  
 STA 345+00 TO STA 359+00

CONTRACT NO. PS-4330-1968  
 DRAWING NO. C-427  
 SCALE: HORIZ: 1" = 100'  
 VERT: 1" = 40'  
 SHEET NO. 0