

CONFIDENTIAL

(Redacted 5-3-19)

SOUTHERN CALIFORNIA REGIONAL RAIL AUTHORITY

EMERGENCY CONTINGENCY PLAN

In case of

WORK STOPPAGE ACTION AGAINST THE MTA

HD
5306
.L6
E97

SCRRRA July 13, 1994

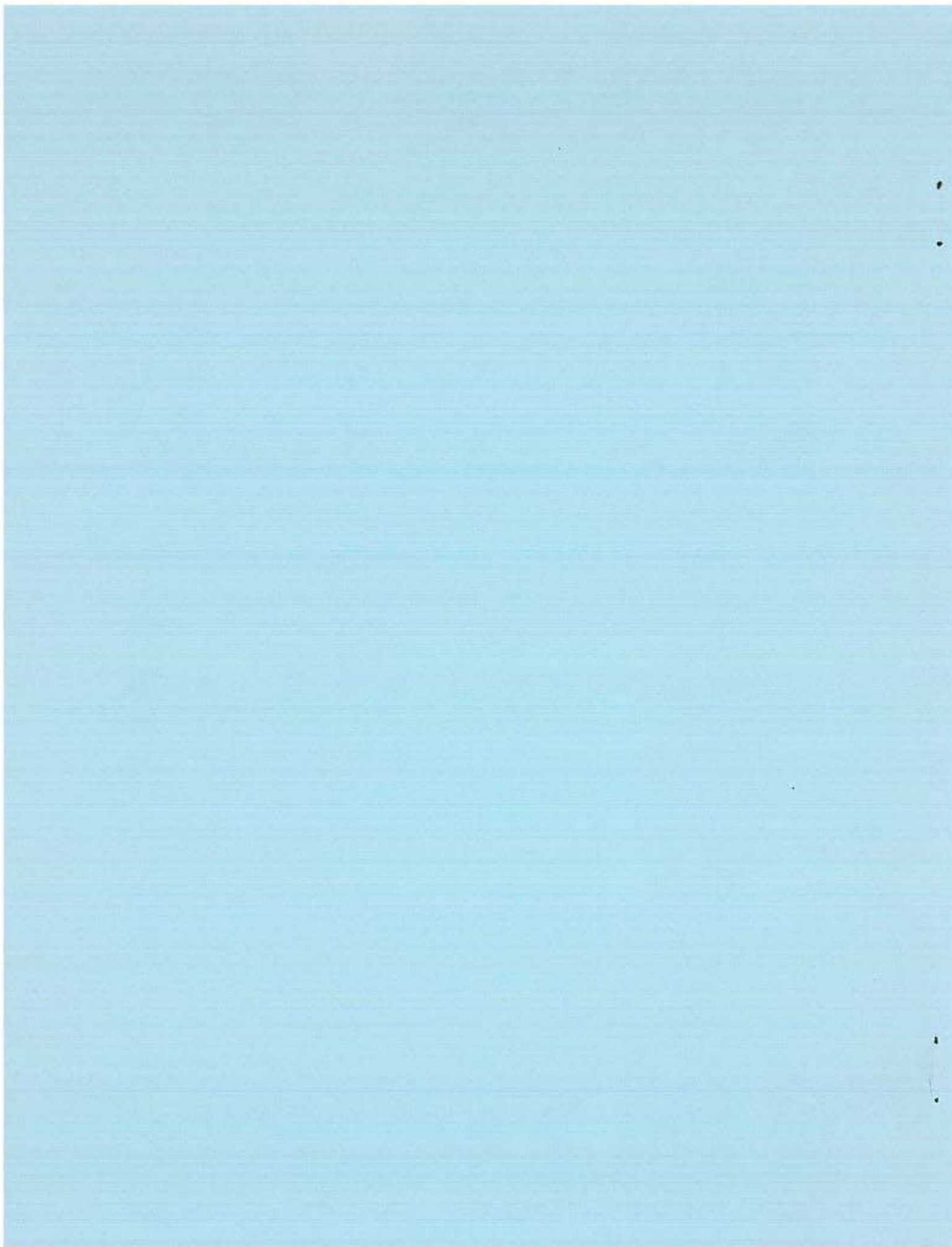

30900941

07 181

INTRODUCTION

THE SOUTHERN CALIFORNIA REGIONAL RAIL AUTHORITY (SCRRA) CONTINGENCY PLAN (CP) IS TO BE READ AND UNDERSTOOD PRIOR TO A WORK STOPPAGE ACTION AGAINST THE OPERATIONS OF THE LOS ANGELES COUNTY TRANSPORTATION AUTHORITY (MTA).

THE PLAN DESCRIBES SCRRA'S ORGANIZATIONAL AND DEPARTMENTAL RESPONSIBILITIES, STAFF RESPONSE AND DEPLOYMENT AND THE RELATIONSHIP OF THIS PLAN TO NORMAL STAFF POSITION FUNCTIONS.

HD
5306
.L6
E97

18174

AUG . 8 '94

CONTENTS

INTRODUCTION

SECTION I	EXECUTIVE INCIDENT COMMAND CENTER
SECTION II	PUBLIC INFORMATION CENTER
SECTION III	OPERATIONS AND PLANNING COMMAND POST
SECTION IV	SYSTEM OPERATING PLAN
SECTION V	SAFETY AND SECURITY
SECTION VI	APPENDIX

1952-1953

1952-1953

1952-1953

1952-1953

1952-1953

1952-1953

1952-1953

1952-1953

1952-1953

1952-1953

1952-1953

1952-1953

1952-1953

1952-1953

1952-1953

1952-1953

1952-1953

1952-1953

1952-1953

1952-1953

1952-1953

1952-1953

1952-1953

1952-1953

1952-1953

1952-1953

1952-1953

1952-1953

1952-1953

1952-1953

1952-1953

1952-1953

1952-1953

1952-1953

1952-1953

1952-1953

1952-1953

1952-1953

1952-1953

1952-1953

1952-1953

1952-1953

1952-1953

1952-1953

RESPONSE PLAN

THE ORDER OF DEPLOYMENT AND COMPLETION OF THE FOLLOWING TASKS IS BASED UPON THE IMMEDIATE AVAILABILITY OF SCRRA STAFF TO ACCOMPLISH THESE FUNCTIONS.

- ESTABLISH AN OPERATIONS AND PLANNING COMMAND POST (OCP) AT THE CENTRAL CONTROL FACILITY
- ESTABLISH A PUBLIC INFORMATION CENTER (PIC) AT THE 818 BUILDING
- ESTABLISH AND MAINTAIN A METROLINK EXECUTIVE INCIDENT COMMAND CENTER (CC) AT THE 818 BUILDING SUPPORTED BY EXECUTIVE DEPARTMENT, LEGAL STAFF AND AMTRAK MANAGER.
- ASSESS SECURITY AND OPERATIONS SAFETY OF THE SYSTEM
- ASSESS OPERATIONAL RESPONSE NEEDS AND CAPABILITIES, TAKING APPROPRIATE RESPONSE ACTIONS
- PROVIDE AND ENSURE PUBLIC INFORMATION BRIEFINGS
- PROVIDE EXECUTIVE COORDINATION WITH THE ACTIVITIES OF THE MTA AND OTHER TRANSIT AGENCIES
- ASSURE CONTINUED METROLINK OPERATIONS UNIMPAIRED BY JOB ACTIONS AGAINST MTA
- DEPLOY FIELD OPERATIONS SUPPORT
- FACILITATE APPROPRIATE LEGAL RESPONSE AS REQUIRED

SECTION I

EXECUTIVE INCIDENT COMMAND CENTER

STAFF SUPPORT

B. NORRIS
L. HOST (1)
A. LEWIN (2)

Shift 1

INCIDENT MANAGERS

DEPUTY EXECUTIVE DIRECTOR

COMMAND STAFF

AMTRAK GENERAL MANAGER
PUBLIC INFORMATION OFFICER
SHERIFFS INCIDENT COMMANDER
SCRIBE - L. HOST

LA LEGAL
SUPPORT
Sandy Langston
Helen Parker

WASHINGTON LEGAL
SUPPORT
Chuck Spitulnik - SCRRRA
John Saperstein - Amtrak

Shift 2

INCIDENT MANAGER

DIRECTOR OF OPERATIONS

COMMAND STAFF

AMTRAK MANAGER
PUBLIC INFORMATION OFFICER
SHERIFFS INCIDENT COMMANDER
SCRIBE - A. LEWIN

PUBLIC INFORMATION CENTER

Public Information Officers

- (1) Ray Shea
- (1) Peter Hidalgo
- (2) Francisco Oaxaca
- (2) Brendan Shepherd

**Passenger Relations &
Facilities Support**

**Sheryl Carrerow (1)
Stuart Chuck (2)
(Ambassadors)**

Mechanical

As Needed
**Bill Lydon (1)
Art Mallette (2)**

Finance

As Needed
**Matt McDonald
Bruce Ferguson
Greg Wong
Raymond Chan**

Field Engineering

As Needed
**Richard Shockley
Dan Guerrero
Ken Koff
Frank Mendoza
Marshall Allen**

* SHIFTS WILL BE COVERED IN 12 HOUR INCREMENTS DESIGNATED AS 1) FIRST SHIFT 4:00 A.M. - 2:00 P.M., (2) SECOND SHIFT 12 Noon - 10:00 P.M..

** ED PEDERSON TO COORDINATE TV FOR EXECUTIVE INCIDENT COMMAND CENTER AND PUBLIC

INFORMATION CENTER (RIVERSIDE ROOM).

CONFERENCE ROOMS

<u>Emergency Phone #'s:</u>	ORANGE COUNTY	SAN BERNARDINO
	(213) 244-7226	244-7222
	244-7227	244-7223
	244-7228	244-7224
	244-7229	244-7225

<u>Regular Phone #'s</u>	X45313	X45314
	(can only be reached through operator (213) 972-6000)	

OPC

Revenue Service

Annette Colfax (1)
John Schwamb (2)

Passenger Service

Karen Sakoda (1)
Rosalia Martinez (2)

Operations

Jack Rich (1)
Georjan Peters (2)

COMMAND CENTER

THE METROLINK INCIDENT COMMAND CENTER (CC) IS STAFFED WITH THE MOST SENIOR OFFICIAL OF EACH DEPARTMENT. THE COMMAND CENTER WILL FUNCTION AS THE POLICY MAKING CENTER OF THE RESPONSE ORGANIZATION.

SCOPE OF THE CC IS TO ENSURE A COORDINATION OF OPERATIONS AND RESPONSE FOR THE DURATION OF THE WORK STOPPAGE.

A UNIFIED INCIDENT COMMAND IS ESTABLISHED WITHIN THE CC TO FACILITATE A PROMPT DECISION MAKING PROCESS. THE SPECIFIC INCIDENT MANAGER WITHIN THE UNIFIED COMMAND IS INITIALLY DESIGNATED AS DEPUTY EXECUTIVE DIRECTOR, DAVID SOLOW. ALSO, PARTICIPATING WITH THE UNIFIED INCIDENT MANAGEMENT IS:

Richard Stanger, Executive Director SCRRRA
Office: (213) 244-6803
Pager: (213) 812-2755

David Solow, Deputy Executive Director SCRRRA
Office: (213) 244-6723
Pager: (213) 812-2771

Bill Currier, Director of Operations SCRRRA

Office: (213) 244-7166

Pager: (213) 812-2757

Lt. Marc Klugman, Metrolink Sheriffs Department

Office: (213) 244-6877

Pager: (213) 971-2291

+ Enter 603568, + Enter your extension + "#"

**WITHIN THE UNIFIED INCIDENT COMMAND, ANY PARTICIPATING
OFFICER MAY ASSUME THE DESIGNATION OF INCIDENT MANAGER.**

**THE STAFF AVAILABLE AT THE COMMAND CENTER IS DESIGNATED AS
FOLLOWS:**

John Skinner, General Manager - Amtrak/Metrolink

Office: (213) 259-6313

Pager: (800) 910-0483

Dave Boger, Director of Engineering - SCRRRA

Office: (213) 244-6738

Pager: (213) 812-2817

Annette Colfax, Director Passenger Facilities - SCRRRA

Office: (213) 244-6553

Pager: (213) 812-2656

**ONCE ACTIVATED AT 4:00 A.M. ON THE DATE OF THE SCHEDULED
WORK STOPPAGE THE COMMAND CENTER WILL BEGIN SITUATION
ASSESSMENT FUNCTIONS.**

LEGAL ELEMENT

KEY FUNCTION OF THIS COMMAND STAFF WILL BE TO DIRECT AND COORDINATE APPROPRIATE LEGAL RESPONSE EFFORTS OF SCRRA, AMTRAK, MTA AND OTHER CONCERNED AGENCIES.

PRIOR TO THE ANTICIPATED WORK STOPPAGE, PREPARED LEGAL DOCUMENTS WILL BE ASSEMBLED FOR THE COMMAND CENTER RESPONSE TO THE FOLLOWING SITUATIONS:

- UTU MTA Employees - SCRRA facility
- UTU MTA & Amtrak Employees - SCRRA facility
- UTU Amtrak Employees - SCRRA or Amtrak facilities

LEGAL STAFF ACCESS IS LIMITED SOLELY TO MEMBERS OF THE COMMAND CENTER TO ENSURE CLEAR AND EFFICIENT DIRECTION.

THE COMMAND CENTER WILL DESIGNATE SPECIFIC REPORTING REQUIREMENTS FOR THE OPC, PIC AND SHERIFF'S OFFICER

LEGAL SUPPORT STAFF:

John Saperstein (202) 906-3191

Joanna Moorhead (202) 906-2855

MTA

Sandy Langston (213) 244-6317

Helen Parker (213) (213) 974-1838

Ann Meeson (213) 972-4610

SECTION II

PUBLIC INFORMATION CENTER

THE PRIMARY ROLE OF THE PUBLIC INFORMATION CENTER (PIC) DURING THE INCIDENT IS TO BOTH PROVIDE CRITICAL INFORMATION THROUGH THE MEDIA TO THE EFFECTED PUBLIC AND CONTROL MEDIA ACCESS TO THE COMMAND CENTER.

ALL RELEASE OF INFORMATION, WHETHER VERBAL OR PRINTED, MUST BE COORDINATED THROUGH THE INFORMATION CENTER AND THE DESIGNATED PUBLIC INFORMATION OFFICER (PIO).

THE PIO WILL PARTICIPATE IN COMMAND CENTER BRIEFINGS TO ENSURE PROMPT ACCESS TO THE COMPLETE, UP-TO-DATE SERVICE STATUS, RESPONSE AND HEALTH AND SAFETY INFORMATION.

THE INFORMATION CENTER WILL COORDINATE SERVICE INFORMATION FLOW TO THE CTS. THE CENTER WILL BE ACTIVATED AT 4:00 A.M. ON THE DATE OF THE SCHEDULED WORK ACTION.

THE FOLLOWING STAFF IS ASSIGNED TO SERVE AT THE INFORMATION CENTER:

Shift 1 Ray Shea, Marketing Manager - SCRRA
Office: (213) 244-6960
Pager: (213) 991-9643

Shift 1 Peter Hidalgo, Media Manager - SCRRA
Office: (213) 244-6142
Pager: (213) 812-2762

Shift 2 Brendan Shepherd, Marketing/Media - SCRRA
Office: (213) 244-7173
Pager: (213) 812-2761

Shift 2 Francisco Oaxaca, Public Affairs - SCRRA
Office: (213) 244-6989
Pager: (213) 812-3028

THE STAFF OF THE PIC WILL MANAGE AND DEPLOY THE APPROVED MARKETING PLAN.

MITIGATION MARKETING PLAN ELEMENT

POSITION: *"METROLINK IS A SEPARATE OPERATING ENTITY FROM THE MTA/METRO. WE WILL CONTINUE TO OPERATE AND PROVIDE WHATEVER CAPACITY WE CAN TO HELP RIDERS DURING THIS LABOR ACTION. WE ARE NEUTRAL REGARDING THE MERITS TO THE ACTION."*

FARE POLICY: TBD

I. MEDIA RELATIONS

A. Position Release (Neutral Regarding Strike)

1. Policy
2. Overall operating picture

B. Customize Releases

1. Stations directly impacted by work stoppage (full list)
2. Station Specific
 - include a list of alternate service
 - include schedule and fare information

C. Duty Desk

1. One person on duty at all times for press contracts
2. Media advisories issued at any time situation changes
3. Daily briefings with MTA and Metrolink operations

II. PAID MEDIA

A. Thematically Neutral

B. Large Space Newspaper Ads Featuring Metrolink Map, Basic Fare Information and Basic Schedule Information

1. An advertisement to be run when labor action appears eminent and during the first week of action
2. Pre-produced
3. Media buy pre-planned and authorized

C. Radio Commercials

1. High frequency drive time schedule
2. Features Metrolink number
3. Pre-produced
4. Media buy pre-planned and authorized

D. Localized Print

1. If appropriate, station specific smaller space advertisements produced
2. To run when labor action appears eminent and throughout duration of the strike
3. Pre-produced
4. Buy prearranged and approved

E. Early station specific Metrolink awareness program

IV. Telephone Information

- A. Full staffing beginning early a.m. when a strike is eminent
- B. Pre-planned script for operators
- C. Automated system message update
- D. Press relations liaison
- E. CCF liaison
- F. 1-800-Commuter support?
- G. Requires extension of CTS contract through risk period.

V. Ambassadors

- A. Prepared script
- B. Full station coverage mornings.
- C. Additional materials
 - 1. Timetables
 - 2. Position statements

VI. ETC Program

- A. Position Statement
- B. Emergency Newsletter
- C. Hotline
- D. 4-Trip Ticket Availability

VII. Passenger Information.

- A. Emphasis.
 - 1. Highlight distinction between SCRRA & MTA
 - 2. We are not part of a labor action.
 - 3. Red Line & Blue Line will continue to run (7/1/94 ???)
- B. Seat drop week of June 27.
- C. Ambassador handouts.

VIII. Other Carriers.

- A. Obtain necessary operating feeder line information for ambassadors.
- B. Encourage Cab & Dash alternatives.

SECTION III

OPERATIONS AND PLANNING COMMAND CENTER

**OPC - Duty Officer Designate
SCRRRA Communications
SCRRRA Planning
Sheriff Liaison Officer
Amtrak Officer Designate
SCRRRA Mechanical**

THE OPC FUNCTION PREPARES AND CARRIES OUT THE APPROVED RESPONSES AS DIRECTED BY INCIDENT COMMAND CENTER.

NORMAL SCHEDULES AND OPERATIONAL PROCEDURES ARE PERFORMED AND OVERSEEN WITH APPROPRIATE RESPONSE OPTIONS PRESENTED TO THE CC. OPC CONTINUALLY ASSESSES THE SYSTEM CAPABILITIES AND PERFORMANCE, ADDRESSING INCIDENTS THAT MAY IMPACT SERVICE DELIVERY.

ROUTINE OPERATIONAL MUTUAL SUPPORT OPERATIONS ARE COORDINATED WITH CONNECTING RAIL CARRIERS AND TRANSIT AGENCIES BY THE OPC STAFF.

THE OPC WILL CONTINUALLY WORK TO IDENTIFY AND DELINEATE THE LOCATION AND AVAILABILITY OF OPERATIONAL RESOURCES TO SUPPORT THE SYSTEM.

SECURITY LIAISON OF THE SHERIFF'S DEPARTMENT WILL BE MAINTAINED IN THE OPC FOR THE DURATION OF THE INCIDENT TO MONITOR SYSTEM OPERATIONAL STRATEGY. THIS SHERIFF'S LIAISON WILL SERVE AS THE ACTIVE COMMUNICATION LINK OF THE OPC/CCF ALONG WITH THE SHERIFF'S OPERATIONS OFFICER.

THE SHIFTS OF SCRRA COMMUNICATIONS COORDINATORS WILL BEGIN AT 5:00 A.M. THROUGH 10:00 P.M.

THE OPC WILL BE ACTIVATED AT 4:00 A.M. ON THE MORNING OF THE SCHEDULED WORK STOPPAGE. THE OPC PHONE NUMBER IS (213) 259-6314/FAX (213) 489-1469.

OPC STAFF MEMBERS ARE AS FOLLOWS:

Lois Cunning, Commuter Relations Officer - Amtrak/Metrolink
Office: (213) 259-6315
Pager: (800) 901-0493

Jack Rich, Operations Planning - SCRRA
Office: (213) 244-6301
Pager: (213) 812-2758

Art Mallette, Equipment Manager - SCRRA
Office: (213) 244-7045
Pager: (213) 812-3113

Bill Lydon, Director of Equipment - SCRRA
Office: (213) 244-6310
Pager: (213) 812-2765

Karen Sakoda, Operations Analyst - SCRRA
Office (213) 244-6298

Rosalia Martinez, Transportation Analyst - SCRRA
Office: (213) 244-7046
Pager: (213) 920-2472

Georjan Peters, Operations Planning & Training Officer - SCRRA
Office: (213) 244-7084
Pager: (213) 968-7978

ASSUMING THE ACTIVATION OF THE OPC, DAY AND EVENING STAFF
COVERAGE SHIFTS WILL BE DEVELOPED TO ENSURE CONTINUOUS
STAFFING OF THE OPC.

SPECIFIC TASK FUNCTIONS OF THE OPC STAFF IS:

- OVERSEE THE DEPLOYMENT OF THE OPERATING PLAN
- ◆ ACT AS CCF ON-SCENE LIAISONS FOR THE EXECUTIVE INCIDENT
COMMANDER CENTER STAFF, ENSURING CONSISTENT
COORDINATION OF OPERATIONS.
- ◆ DEVELOP ADDITIONAL LOGISTICS AND SERVICE PROTECTION
STRATEGIES AS NEEDED DUE TO CHANGES IN THE OPERATING PLAN
- ◆ ENSURE DEFINITIVE ACTIONS WHEN OPERATING PLAN
INTERRUPTIONS OCCUR.

- ◆ ENSURE AND PROVIDE CONSTANT OPERATIONAL COMMUNICATION FLOW TO BOTH THE CC AND THE PIC.
- ◆ INSULATE FROM EXTRA FUNCTIONAL REQUIREMENTS AND ASSIST FIRST LINE OPERATIONS STAFF IN MANAGEMENT OF SERVICE DELIVERY, ACTING AS AN ADDITIONAL OPERATING RESOURCE.
- ◆ PREPARE AND DISTRIBUTE OPERATIONAL REPORTS AND SUMMARIES AS REQUIRED BY CC.

THE OPC WILL BE ASSIGNED ONE VEHICLE TO PROVIDE FOR FIELD SUPPORT AND COMMUNICATION AS REQUIRED. ASSIGN VEHICLE #83 FROM MTA POOL.

SECTION IV

SYSTEM OPERATING PLAN

RESPONSE

THE FOLLOWING ELEMENTS WILL FORM THE PRIMARY OBJECTIVE OF SCRRA'S OPERATIONAL RESPONSE.

PARALLEL LINE CAPABILITIES AND RESPONSE

EQUIPMENT ELEMENT

BASED ON PRIOR REVIEW, METROLINK'S 7-CAR (148 SEATED CAPACITY) RESERVE CAR FLEET IS DISTRIBUTED AS FOLLOWS IN ORDER OF PRIORITY.

CONSISTS WILL BE INCREASED THREE DAYS BEFORE EXPECTED WORK STOPPAGE DATE (JULY 29 OR AUGUST 29).

SAN BERNARDINO LINE

TRAIN COUPLET 300-301-311-316-321-320

Increased from 3-car (444 seated) to 4-car (592 seated)

TRAIN COUPLET 302-309-313-318

Increased from 3-car (444 seated) to 4-car (592 seated)

TRAIN COUPLET 304-315-306-317-308-319-109

Increased from 4-car (592 seated) to 5-car (740 seated)

RIVERSIDE LINE

TRAIN COUPLET 400-407-402-405

Increased from 4-car (592 seated) to 5-car (740 seated)

TRAIN COUPLET 209-406

Increased from 4-car (592 seated) to 5-car (740 seated)

OXNARD/MOORPARK LINE

TRAIN COUPLET 109 - 102

Increased from 4-car (592 seated) to 5- car (740 seated)

TRAIN COUPLET 111-106-101-108

Increased from 4-car (592 seated) to 5-car (740 seated)

THE ABOVE PLAN ASSURES THAT NORMAL EQUIPMENT MAINTENANCE
CYCLES ARE PRESERVED AND THAT A 3-CAR EMERGENCY CONSIST IS
AVAILABLE AT TAYLOR YARD.

DURING THE DURATION OF THE INCIDENT, A RESERVE CREW WILL BE CALLED TO PROTECT IMMEDIATE ACTIVATION OF THE EMERGENCY 3-CAR CONSIST. WHILE THIS EMERGENCY SET WILL BE CALLED WITH A SAN BERNARDINO QUALIFIED CREW, LA AMTRAK/ METROLINK SUPERVISORS WILL BE AVAILABLE TO PILOT THE CONSIST TO ANY LOCATION ON THE SYSTEM.

OPERATION ELEMENT

METROLINK WILL PROVIDE ADDITIONAL SERVICES ON THE CHATSWORTH-BURBANK-LOS ANGELES CORRIDOR IN THE EVENT OF A MTA WORK STOPPAGE.

SCHEDULES FOR CHATSWORTH SERVICES ARE INCLUDED IN SECTION VI - APPENDIX OF THIS PLAN.

AMTRAK WILL BE DIRECTED IN WRITING BEFORE THE ANNOUNCED DATE OF THE WORK STOPPAGE TO DO THE FOLLOWING

TASKS:

- 1- MINIMIZE CREW LAYOFF AND MAXIMIZE SYSTEM CREW AVAILABILITY
- 2- SPECIAL TRAIN SERVICE FOR SCHOOL GROUPS AND PRIVATE CONTRACTORS WILL CEASE FOR DURATION OF THE WORK STOPPAGE

- 3- ROUTINE FARE INSPECTION WILL CEASE FOR FIRST DAY OF THE WORK STOPPAGE
- 4- ASSISTANT CONDUCTORS WILL BE HELD IN RESERVE
- 5- ARRANGEMENTS ARE BEING MADE FOR A 4-DAY HONORING OF MTA MONTHLY PASSES, ASSUMING MTA REIMBURSEMENT PLAN IS DEVELOPED
- 6- COUNTS CONTINUE TO BE MADE
- 7- AMTRAK/METROLINK LAUS PLATFORM SUPERVISORS MAY HOLD LAST PEAK LAUS DEPARTURE PENDING RED LINE CONNECTIONS
- 8- TOP OFF FUELING OF ALL CONSISTS PRIOR TO TAYLOR DEPARTURE ON ANTICIPATED DATE PRIOR TO STRIKE. IF LIMITED ADVANCE NOTICE, PROVISION FOR LAYOVER RE-FUELING WILL BE MADE.
- 9- FIELD OPERATIONS OFFICERS DEPLOYED TO TAYLOR, LAUS AND AT OUTLYING FACILITIES PRIOR TO CREW ON-DUTY TIMES TO NORMAL OPERATION

10- DEPLOYMENT OF AMTRAK GENERAL MANAGER TO
CENTRAL CONTROL FACILITY BY 4:00 A.M. ON THE DATE
OF WORK STOPPAGE

11- AMTRAK LEGAL STAFF REPRESENTATIVE IN PLACE,
CONTACT WITH GENERAL MANAGER AT THE
COMMAND CENTER

12- ATM COVERAGE AT CCF BEFORE MIDNIGHT OF DAY
SCHEDULED WORK STOPPAGE

13- TRACK PATROL AFTERNOON PRIOR TO WORK STOPPAGE

REVENUE ELEMENT

PRIOR TO INCIDENT, A PLAN FOR FIELD REVENUE COLLECTION WILL
BE DEVELOPED BY THE SCRRA REVENUE MANAGER.

FEATURES OF THE PLAN WILL INCLUDE:

- PRIOR CONTRACTOR FARE COLLECTION CONTRACTS
- DESIGNATION OF HOURS OF OPERATION AND LOCATION OF
FIELD COLLECTION SITES
- DEVELOPMENT OF COLLECTION METHODS

THE SCRRA MANAGER OF REVENUE WILL BE AVAILABLE DURING THE
INCIDENT AT THE 818 BUILDING:

John Schwamb, Revenue Manager - SCRRA
Office: (213) 244-6589
Pager: (213) 812-2753

FIELD REVENUE COLLECTION PROCEDURES

- ◆ AT LA UNION STATION, TICKETS WILL BE SOLD FROM THE METROLINK WINDOW AS WELL AS FROM THE METROLINK INFORMATION BOOTH. TICKETS WILL BE SOLD AT THESE LOCATION FROM 6:30 A.M. UNTIL 6:00 P.M.
- ◆ AS REQUIRED, REVENUE SERVICING OF THE TICKET VENDING MACHINES WILL BE INCREASED TO ACCOMMODATE ANY INCREASED SALE ACTIVITY.
- ◆ ASCOM WILL HAVE A FIELD REPRESENTATIVE WORKING SATURDAY, JULY 2, TO MAKE ANY NECESSARY TVM REPAIRS.
- ◆ ASCOM WILL BE DIRECTED TO HAVE TWO FIELD REPRESENTATIVES ASSIGNED TO THE SAN BERNARDINO AND SANTA CLARITA/LANCASTER LINES STARTING AT 5:00 A.M. ON TUESDAY, JULY 5.

ENGINEERING ELEMENT

(INCLUDES SIGNAL, BRIDGE & TRACK MAINTENANCE & INSPECTION)

PRIOR TO THE INCIDENT:

1. NORMAL SYSTEM FACILITY INSPECTIONS WILL CONTINUE.
2. MAINTENANCE CONTRACTORS WILL DEVELOP A PLAN TO MOVE EMPLOYEE HEADQUARTERS AWAY FROM MTA PROPERTY OR OUT OF LOS ANGELES COUNTY FOR THE DURATION OF THE INCIDENT. SUFFICIENT TOOLS AND EQUIPMENT WILL BE RELOCATED AS NECESSARY.
3. FIELD MAINTENANCE SUPERVISORS WILL PREPARE TO WORK OUT OF THEIR VEHICLE FOR THE DURATION.
4. LAYOFFS WILL BE MINIMIZED OR ELIMINATED AS NECESSARY.

DURING THE INCIDENT:

1. FIELD ENGINEERING RESPONSE PERSONNEL (SEE PAGE 15)
INCLUDING JAY CRAFT AND PAUL DOLPH WILL ARRANGE FOR AND
BEGIN FACILITY INSPECTIONS USING ALL AVAILABLE MAINTENANCE
PERSONNEL AS REQUIRED.
 - A. PRIORITY WILL BE TO INSPECT AHEAD OF PASSENGER TRAINS
ON OUR TRACK THAT HAS NOT BEEN USED FOR FOUR OR
MORE HOURS IN LOS ANGELES COUNTY.
 - B. SECOND PRIORITY WILL BE TO ARRANGE FOR REGULAR
INSPECTIONS OF CRITICAL POTENTIAL HAZARDS SUCH AS
TUNNELS, CERTAIN BRIDGES AND SWITCHES IN HIGHER SPEED
TRACKS LOCATED IN ISOLATED AREAS. RESPONSE TEAM
SHOULD USE THEIR EXPERIENCE IN SELECTING THESE AREAS.
 - C. THIRD PRIORITY WILL BE A CONTINUOUS SYSTEM
INSPECTION AT LEVELS EXCEEDING NORMAL INSPECTION
FREQUENCIES AS REQUIRED. INSPECTIONS WILL CONTINUE
SEVEN DAYS A WEEK THROUGHOUT THE INCIDENT.
2. MAINTENANCE AND INSPECTION COORDINATORS FROM THE SCRRRA
AND THE CONTRACTORS WILL MONITOR THE INSPECTION
ACTIVITIES FROM THE CCF AT (213) 256-0737 OR (800) 618-7446.

INSPECTORS WILL BE REQUIRED TO REPORT ANYTHING UNUSUAL SUCH AS PICKETS, VANDALS, TRESPASSERS, ETC. PROGRESS OF INSPECTION WILL BE LOGGED. WORK SHIFTS WILL BE DEVELOPED BY THE CO-COORDINATORS SO EVERYBODY GETS REQUIRED REST.

3. MAINTENANCE AND INSPECTION COORDINATORS WILL REPORT TO THE COMMAND CENTER STAFF.
4. PROJECT MANAGER DESIGN & MAINTENANCE WILL TROUBLE SHOOT AT CCF AND IN THE FIELD AS REQUIRED BY COMMAND CENTER STAFF.
5. SIGNAL AND COMMUNICATION MAINTENANCE WILL BE ACCOMPLISHED THROUGH A CONTINUATION OF THE NORMAL MAINTENANCE PATTERNS.
6. A GREATER SENSITIVITY TO THE NETWORK'S POTENTIAL PROBLEMS SHOULD BE ACKNOWLEDGED BY ANTICIPATING THIS SPECIAL EMERGENCY CIRCUMSTANCE.
7. THE "HOURS-OF-SERVICE RULES" WILL BE OBSERVED.

8. THE MAINTENANCE VEHICLES WILL HAVE THE NORMAL COMPLEMENT OF ESSENTIAL MATERIAL TO MAKE ANY NORMAL REPAIRS.
9. EXTRA RADIOS AND ASSOCIATED INTERFACES WILL BE REMOVED FROM STORAGE AND LOADED INTO THE VEHICLES TO REDUCE RESPONSE TIME.
10. THE GOAL IS FOR THE ENTIRE STAFF TO BE PREPARED TO RESPOND AS THE NEEDS ARISE.

FINANCE ELEMENT

THE FINANCE ELEMENT OF THE GENERAL OPERATING PLAN IS ESTABLISHED TO MANAGE AND PROPERLY IDENTIFY COSTS RELATED UNIQUELY TO THE WORK STOPPAGE INCIDENT.

A PLAN WILL BE DEVELOPED BY THE FINANCE SECTION TO ESTABLISH PROPER COST CODES FOR THE BUDGET BEFORE AN INCIDENT.

FINANCE WILL PARTICIPATE IN THE MAKING OF SPECIAL SERVICE ARRANGEMENTS SUCH AS THE HONORING OF MTA FARE MEDIA.

THE SCRRA FINANCE TEAM WILL BE AVAILABLE DURING
INCIDENT AT THE 818 BUILDING:

Matthew McDonald, Finance Manager - SCRRA
Office: (213) 244-7039

Bruce Ferguson, Senior Cost Administrator - SCRRA
Office: (213) 244-6192

Greg Wong, Cost Administrator - SCRRA
Office: (213) 244-7157

FINANCE WILL COORDINATE ACTIVITIES WITH CONTRACT ADMINISTRATION
STAFF TO INSURE PRIOR NOTIFICATION HAS BEEN TRANSMITTED TO SCRRA
CONTRACTORS ALLOWING FOR COST IDENTIFICATION PROCEDURES.

[ANTICIPATED COSTS]

SECTION V

SAFETY AND SECURITY

THIS SECTION DOCUMENTS THE MISSION AND DEPLOYMENT PLAN OF THE SECURITY AND SAFETY ELEMENT OF SCRRA CONTINGENCY PLAN. INTENT IS TO PROVIDE THE GUIDELINES FOR THE ABILITY TO RESPOND TO EVENTS REQUIRING A MAXIMUM LEVEL OF SECURITY AND SAFETY.

ACTING IN CONCERT WITH THE INCIDENT COMMAND OF THE SHERIFF'S OFFICE IS THE SCRRA MANAGER OF SAFETY. HE PARTICIPATES AS REQUIRED IN ALL BRIEFING SESSIONS CONDUCTED WITH EXECUTIVE MANAGEMENT AT THE COMMAND CENTER.

METROLINK SHERIFF'S UNIT

MISSION

THE MISSION OF THE SHERIFF'S METROLINK UNIT DURING ANY LABOR ACTION IS THE PROTECTION OF TRANSIT PATRONS, OPERATORS AND EQUIPMENT (INCLUDING THE PREVENTION OF VANDALISM, INTIMIDATION AND INTERRUPTIONS IN REVENUE SERVICE), AND ENSURING THE MAINTENANCE OF A SAFE OPERATIONAL ENVIRONMENT.

CONCEPT OF OPERATION

ALL SHERIFF'S PERSONNEL MUST REMAIN COGNIZANT OF DEPARTMENTAL OBJECTIVES DURING ANY LABOR ACTION OR STRIKE.

THESE OBJECTIVES ARE:

- PROTECT LIFE AND PROPERTY
- ENFORCE ALL LAWS AND ORDINANCES FAIRLY AND IMPARTIALLY. ALL LAWS REMAIN IN FORCE
- ALL PERSONNEL SHALL REMAIN TOTALLY OBJECTIVE REGARDING THE DISPUTE
- THE RIGHTS OF ALL CITIZENS WILL BE PROTECTED.
 - LABOR MAY PROTEST OR PICKET LAWFULLY
 - MANAGEMENT MAY CONTINUE TO FUNCTION
 - THE PUBLIC RETAINS THE RIGHT TO UTILIZE THE SYSTEM WITHOUT INTERRUPTION

TO ENSURE UNIFORM KNOWLEDGE OF THESE OBJECTIVES BY ALL SHERIFF'S PERSONNEL, THE DEPARTMENTAL FLYER ENTITLED "LABOR DISPUTES" WILL BE DISTRIBUTED TO ALL FIELD PERSONNEL PRIOR TO THE COMMENCEMENT OF ANY JOB ACTION. ALL PERSONNEL WILL SIGN AN ACKNOWLEDGMENT RECEIPT AND RECEIVE A BRIEFING FROM A SPECIALIST ASSIGNED TO THE DEPARTMENTS INDUSTRIAL RELATIONS DETAIL.

THE SHERIFF'S METROLINK UNIT WILL MAINTAIN LIAISON WITH THE INDUSTRIAL RELATIONS DETAIL, AND ALL OTHER INVOLVED PARTIES THROUGHOUT THE DURATION OF THE STRIKE.

STRIKE PENDING

WHEN IT APPEARS AN ACTUAL LABOR DISPUTE IS IMMINENT, THE METROLINK UNIT COMMANDER ASSUMES THE ROLE OF SHERIFF'S UNIT INCIDENT COMMANDER AND TRANSMIT A PRE-EVENT MEMO TO THE INDUSTRIAL RELATIONS DETAIL ACCORDING TO DEPARTMENTAL POLICY.

LIAISON WITH THE MTAPD, THE LAPD, AND ALL OTHER LAW ENFORCEMENT INVOLVED WITH THE METROLINK SYSTEM, ITS OPERATING RIGHT-OF-WAY AND FACILITIES, PARKING LOTS, OR TRAIN STATIONS WILL BE INITIATED DURING THIS PHASE OF OPERATIONS. THE SHERIFF'S METROLINK UNIT WILL MAINTAIN NORMAL OPERATIONS AND DEPLOYMENT.

PRE-STRIKE

WHEN AN ACTUAL STRIKE IS CALLED, INDUSTRIAL RELATIONS DETAIL IS NOTIFIED IMMEDIATELY BY TELEPHONE. THE SHERIFF'S METROLINK UNIT WILL ACTIVATE A STRIKE INFORMATION CENTER THAT WILL FORM THE INTELLIGENCE SECTION OF THE ICS STRUCTURE. PERSONNEL ASSIGNED TO THE INTEL SECTION WILL

MAINTAIN CONTACT WITH THE MTAPD, LAPD AND OTHER LAW ENFORCEMENT AGENCIES INVOLVED WITH THE STRIKE.

DURING THIS PRE-STRIKE PERIOD, ROUTINE PATROLS WILL BE MAINTAINED; HOWEVER, DEPUTIES WILL BE INSTRUCTED TO CONDUCT AND LOG REGULARLY.

FIELD PATROLS WILL CONDUCT SCHEDULED INSPECTIONS OF FACILITIES AND EQUIPMENT MAINTAINED BY THE SCRRA. ANY UNUSUAL SITUATION WILL BE REPORTED TO THE METROLINK INCIDENT COMMANDER. A TACTICAL ALERT WILL BE ISSUED VIA THE CHAIN COMMAND ALERTING ALL DEPARTMENTAL SUPPORT UNITS THAT THEIR RESPONSE TO THE EVENT MAY BE REQUIRED.

DURING THE ACTUAL STRIKE PERIOD, METROLINK DEPUTIES WILL BE GIVEN SPECIFIC ASSIGNMENTS AS DETERMINED BY THE INCIDENT COMMANDER. POTENTIAL ASSIGNMENTS WILL INCLUDE DEPLOYMENT AT THE CCF, UNION STATION, TAYLOR YARD, LAYOVER POINTS AND PICKET SITES. SHOULD ADDITIONAL RESOURCES BE REQUIRED, THEY WILL BE REQUESTED FROM SUPPORTING SHERIFF'S STATIONS.

ALL FIELD DEPLOYMENTS WILL BE ADJUSTED TO MEET SPECIFIC NEEDS THAT MAY ARISE FROM STRIKE RELATED EVENTS.

DEPLOYMENT ALLOCATION WILL BE THE RESPONSIBILITY OF THE INCIDENT COMMANDER.

COMMAND AND COMMAND POST

THE SHERIFF'S INCIDENT COMMANDER WILL BE LIEUTENANT MARC KLUGMAN, DEPUTY INCIDENT COMMANDER WILL BE SERGEANT LEE SMITH. THE ON-DUTY FIELD SERGEANT WILL SERVE AS THE OPERATIONS OFFICER IN CHARGE. THE OPS OIC IS RESPONSIBLE FOR TACTICAL COMMAND AND CONTROL AND COORDINATION OF FIELD UNITS ASSIGNED TO THIS OPERATION.

THE COMMAND POST WILL BE AT THE METROLINK HEADQUARTERS, 818 WEST 7TH STREET, LOS ANGELES, 7TH FLOOR OFFICES. THE RADIO FREQUENCY FOR COMMAND AND OPERATIONS IS DISPATCH NINE (9). THE RADIO FREQUENCY FOR TACTICAL OPERATIONS IS DESIGNATED BY SHERIFF'S RADIO CENTER (SRC) AS REQUIRED.

MEDICAL

EMERGENCY MEDICAL TREATMENT WILL BE PROVIDED BY LOCAL PARAMEDICS.

IF ADDITIONAL TREATMENT IS DEEMED NECESSARY, INJURED SWORN PERSONNEL WILL BE TRANSPORTED TO THE NEAREST EMERGENCY MEDICAL FACILITY. REFER TO THE METROLINK MANUAL FOR THE LOCATION OF THE NEAREST HOSPITAL.

ANY INJURED SUSPECTS WILL BE TRANSPORTED TO:

LOS ANGELES COUNTY/USC MEDICAL CENTER

1200 NORTH STATE STREET, BOYLE HEIGHTS

PHONE: (213) 226-6707 - EMERGENCY

(213) 226-4563 - JAIL WARDS

ADMINISTRATIVE

AT THE ONSET OF THE ACTUAL STRIKE, A COMPLAINT REPORT WILL BE INITIATED. THIS REPORT WILL DESCRIBE THE STATUS OF NEGOTIATIONS AND AREAS OF CONFLICT AS WELL AS ARTICULATE MANAGERMENTS' INTENT REGARDING CONTINUING OPERATIONS. ALL NON-CRIMINAL STRIKE RELATED ACTIVITIES WILL BE DOCUMENTED IN SUPPLEMENTAL REPORTS TO THE INITIAL STRIKE REPORT. ALL CRIMINAL ACTIVITY WILL BE REPORTED AND PROCESSED ACCORDING TO STANDARD DEPARTMENTAL POLICY. INDUSTRIAL RELATIONS DETAIL SHALL BE NOTIFIED BY TELEPHONE OF ALL CRIMINAL STRIKE RELATED ACTIVITY.

ALL OTHER DEPARTMENTAL REPORTING PROCEDURES ARE IN EFFECT. STANDARD MEMORANDA REGARDING SHOTS FIRED, TEAR GAS, INJURED DEPUTIES, USE OF FORCE, ETC., SHALL BE MADE THROUGH CHANNELS TO THE OPERATION'S INCIDENT COMMANDER.

ALL NOTEWORTHY INCIDENTS INVOLVING MEMBERS OF THE PRESS, VIP'S PUBLIC OFFICIALS, TRANSIT PERSONNEL OR UTU OFFICIALS REQUIRE IMMEDIATE VERBAL NOTIFICATION TO THE INCIDENT COMMANDER.

ANYONE ARRESTED DURING THE OPERATION WILL BE TRANSPORTED TO THE NEAREST SHERIFF'S FACILITY FOR BOOKING. THE INCIDENT COMMANDER, THE INDUSTRIAL RELATIONS DETAILS AND THE METROLINK DETECTIVES WILL BE IMMEDIATELY NOTIFIED OF ALL OPERATIONS RELATED ARRESTS. ALL EVIDENCE COLLECTED WILL BE HANDLED ACCORDING TO EXISTING SHERIFF'S METROLINK POLICY.

COPIES OF ALL MEMORANDA, ARREST OR INCIDENT REPORTS, DAILY LOGS AND OTHER PERTINENT INFORMATION, WILL BE FORWARDED TO THE STRIKE INFORMATION CENTER AT A MINIMUM OF ONCE A DAY.

MISCELLANEOUS INFORMATION

TYPICALLY, VANDALISM AND OTHER MALICIOUS MISCHIEF IN A PROTRACTED STRIKE CAN BE EXPECTED AT SWITCH LOCATIONS AND COMMUNICATIONS CENTERS. YARDS AND SHOPS ARE ALSO COMMON TARGETS OF DISGRUNTLED EMPLOYEES.

AS MUCH AS POSSIBLE, METROLINK EQUIPMENT SHOULD BE MARSHALED AND MAINTAINED IN CENTRAL AREAS WITH ADEQUATE LIGHTING AND SECURITY.

ADDITIONAL SECURITY THROUGH U.S. GUARDS COVERING THE AFOREMENTIONED LOCATIONS SHOULD BE CONSIDERED. LIGHTING REQUIREMENTS SHOULD BE RE-EVALUATED AND, WHERE NECESSARY, ADDITIONAL TEMPORARY LIGHTING INSTALLED.

GRADE-CROSSING ENFORCEMENT SHOULD BE MAINTAINED DURING THE STRIKE. HISTORICALLY DURING A STRIKE, GRADE-CROSSING VIOLATIONS INCREASE AS THE PERCEPTION IS THAT NO ENFORCEMENT ACTIVITY IS OCCURRING.

METROLINK MANAGEMENT SHOULD DECIDE WHOM THEY WISH TO SERVE WITH TEMPORARY RESTRAINING ORDERS AND WHERE THOSE INDIVIDUALS CAN BE LOCATED.

MANAGEMENT SHOULD BE PREPARED TO INITIATE A BUS BRIDGE FROM ANY LOCATION AS THE RESULT OF A STRIKE RELATED INCIDENT AND HAVE LIAISON WITH THE LOCAL BUS COMPANIES.

IN CASE OF AN ACT OF VANDALISM OR OTHER STRIKE RELATED INCIDENT OF A CRIMINAL NATURE, PERSONS CARRYING UTU IDENTIFICATION SHOULD BE DETAINED OR IDENTIFIED FOR INVESTIGATION BY THE APPROPRIATE LAW ENFORCEMENT AGENCY.

SAFETY AND SECURITY DEPLOYMENT

INCIDENT COMMAND & SAFETY

818 CC

OPERATIONS & PLANNING COMMAND CENTER

Security Liaison
(2 shifts)

SHERIFF'S TACTICAL OPERATIONS COMMAND

OIC
Field

Union Station

Taylor Yard

Field Unit for Patrol

Note: MTAPD will assume primary responsibility too secure and coordinate security around LAUS. LAPD will respond, if necessary, to support MTAPD. MTAPD will designate where pickets will be allowed.

IN REFERENCE TO THE CONTINGENCY PLAN FOR THE UTU BUS OPERATORS WORK STOPPAGE, THE FOLLOWING LOCATIONS ARE SITES WHERE PICKETS COULD DISRUPT COMMUTER OPERATIONS.

LA UNION STATION	800 N. ALAMEDA
TAYLOR YARD MAINTENANCE FACILITY	1555 SAN FERNANDO ROAD
CENTRAL CONTROL FACILITY	3370 SAN FERNANDO ROAD
EL MONTE STATION	10925 RAILROAD STREET
BURBANK STATION	210 FRONT STREET
GLENDALE STATION	400 WEST CERRITOS AVENUE
SYLMAR STATION	12219 NORTH FIRST STREET
SANTA CLARITA STATION	22122 SOLEDAD CANYON RD
CLAREMONT STATION	200 WEST 1ST STREET
MONTCLAIR STATION	5091 RICHTON STREET
VAN NUYS STATION	7720 VAN NUYS BOULEVARD
CHATSWORTH STATION	21510 DEVONSHIRE STREET

THESE SITES ARE POSSIBLE LOCATIONS WHERE WE MAY ENCOUNTER PICKETS LISTED IN PRIORITY ORDER. IN ADDITION, THESE ARE LOCATIONS WHERE WE HAVE EMPLOYEES GOING TO AND FROM WORK, AND STATIONS WHERE WE ANTICIPATE COMMUTERS SEEKING ALTERNATE TRANSPORTATION. AT LOS ANGELES UNION STATION THERE ARE SEVERAL ENTRANCES AND EXITS. THE L.A. UNION STATION PRIMARY ENTRANCE IS 800 NORTH ALAMEDA. A SECONDARY ENTRANCE IS 413 EAST BAUCHET FOR TERMINAL TOWER. THERE IS A BUS ENTRANCE ON ALAMEDA, AND A BUS EXIT ON MACY STREET.

SECTION VI

SOUTHERN CALIFORNIA REGIONAL RAIL AUTHORITY

SERVICE RESPONSE PLAN

<u>NAME</u>	<u>LOCATION</u>	<u>HOME#</u>	<u>PAGER#</u>
Allen, Marshall	Field Engineer		(213) 812-3102
Brooks-Taylor, Adrienne	Command Center		(213) 506-7185
Carrerow, Sheryl	Command Center		(213) 963-5157
Chan, Raymond	Station Support [Covina]		N/A
Chuck, Stuart	Command Center		(213) 812-3162
Cluster, Louis	Station Support [Sylmar]		(213) 812-2671
Colfax, Annette	Command Center		(213) 812-2656
Crary, Gray	Station Support [Glendale]		(213) 812-3105
Currier, Bill	Command Center		(213) 812-2757
Daley, Rhonda	Command Center		(213) 968-7411
Eaglin-Modster, Leotha	Station Support [El Monte]		N/A
Ferguson, Bruce	Command Center [Fullerton]		N/A
Glor, Gordon	Station Support [Van Nuys]		N/A
Guerrero, Dan	Field Engineer		(213) 812-3025
Hancock, David	Command Center [Burbank]		(213) 920-2474

Harris, David	Station Support [Montclair]	(213) 961-6726
Hidalgo, Peter	Public Info Center	(213) 812-2762
Hoard, Claude	Station Support [Burbank]	N/A
Host, Lorraine	Command Center	N/A
Lewin, Alice	Command Center	N/A
Livingstone, George	Station Support [Industry]	N/A
Lydon, Bill	Ops & Plning-CCF [Pedley]	(213) 812-2765
Mallette, Arthur	Ops & Plning-CCF [Riverside]	(213) 812-3113
Martinez, Rosalia	Ops & Plning-CCF	(213) 920-2472
Mathieu, Ronald	Station Support [Claremont]	(213) 812-3107
McDonald, Matthew	Command Center [Covina]	N/A
McGinley, Michael	Field Engineer	(213) 812-2796
McNeil-Kakaris, Evangelia	Station Support [Fullerton]	N/A
Mendoza, Frank	Field Engineer	(213) 812-2816
Norris, Barbara	Command Center	N/A
Oaxaca, Francisco	Public Info Center	(213) 812-3028
Pederson, Edward	Com Cnt/Field Sup [Glendale]	(213) 968-8764
Peters, Georjan	Ops & Plning-CCF [Industry]	(213) 968-7978
Rich, Jack	Ops & Plning-CCF	(213) 812-2758

Schoengarth, Miriam	Command Center	N/A
Schwamb, John	Command Center	(213) 812-2753
Shah, Jack	Station Support [El Monte]	(213) 812-3124
Sakoda, Karen	Ops & Plning-CCF	N/A
Shea, Raymond	Public Info Center	(213) 991-9643
Shepherd, Brendan	Public Info Center	(213) 812-2761
Shockley, Richard	Ops & Plning-CCF	(213) 812-2763
Solow, David	Command Center	(213) 812-2771
Stanger, Richard	Command Center	(213) 812-2755
Suehiro, Lloyd	Station Support [Santa Clarita]	(213) 920-2480
Tinkham, Clayton	Station Support [Baldwin Park]	N/A
Warner, Nancy	Station Support [Chatsworth]	(213) 961-9161
Watson, Harold	Field Engineer	(213) 812-3110

STREET LEVEL PLAN

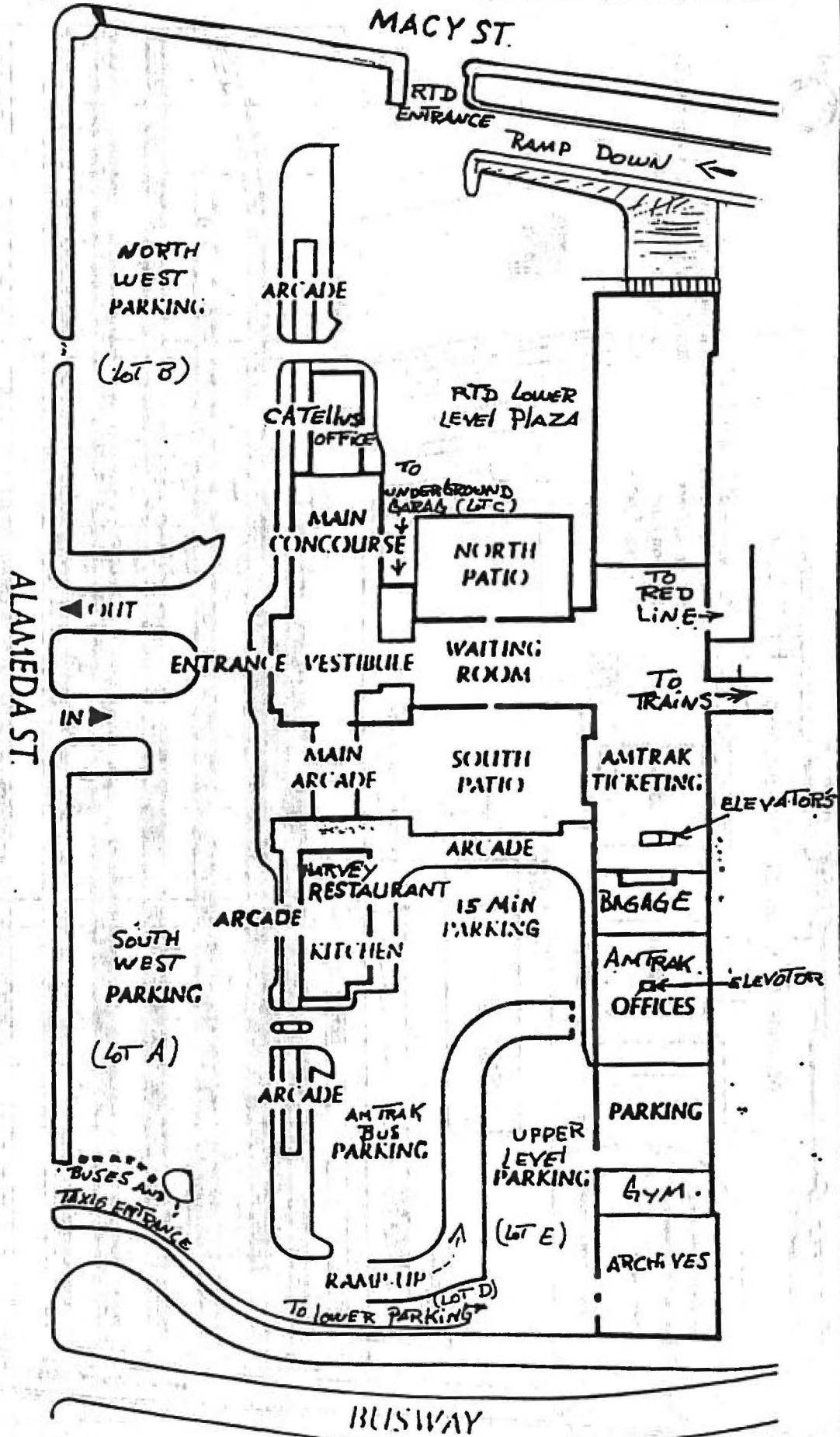

<p>REVISIONS</p> <table border="1"> <tr> <th>NO.</th> <th>DATE</th> <th>DESCRIPTION</th> </tr> <tr> <td> </td> <td> </td> <td> </td> </tr> <tr> <td> </td> <td> </td> <td> </td> </tr> </table>	NO.	DATE	DESCRIPTION							<p>DESIGNER</p> <p> </p>	<p>CHECKER</p> <p> </p>	<p>DATE</p> <p> </p>	<p>PROJECT</p> <p> </p>	<p>SCALE</p> <p> </p>
NO.	DATE	DESCRIPTION												
<p>LACTIC CENTRAL STORAGE & MAINTENANCE FACILITY</p>														
<p>SITE LOCATION PLAN</p>														

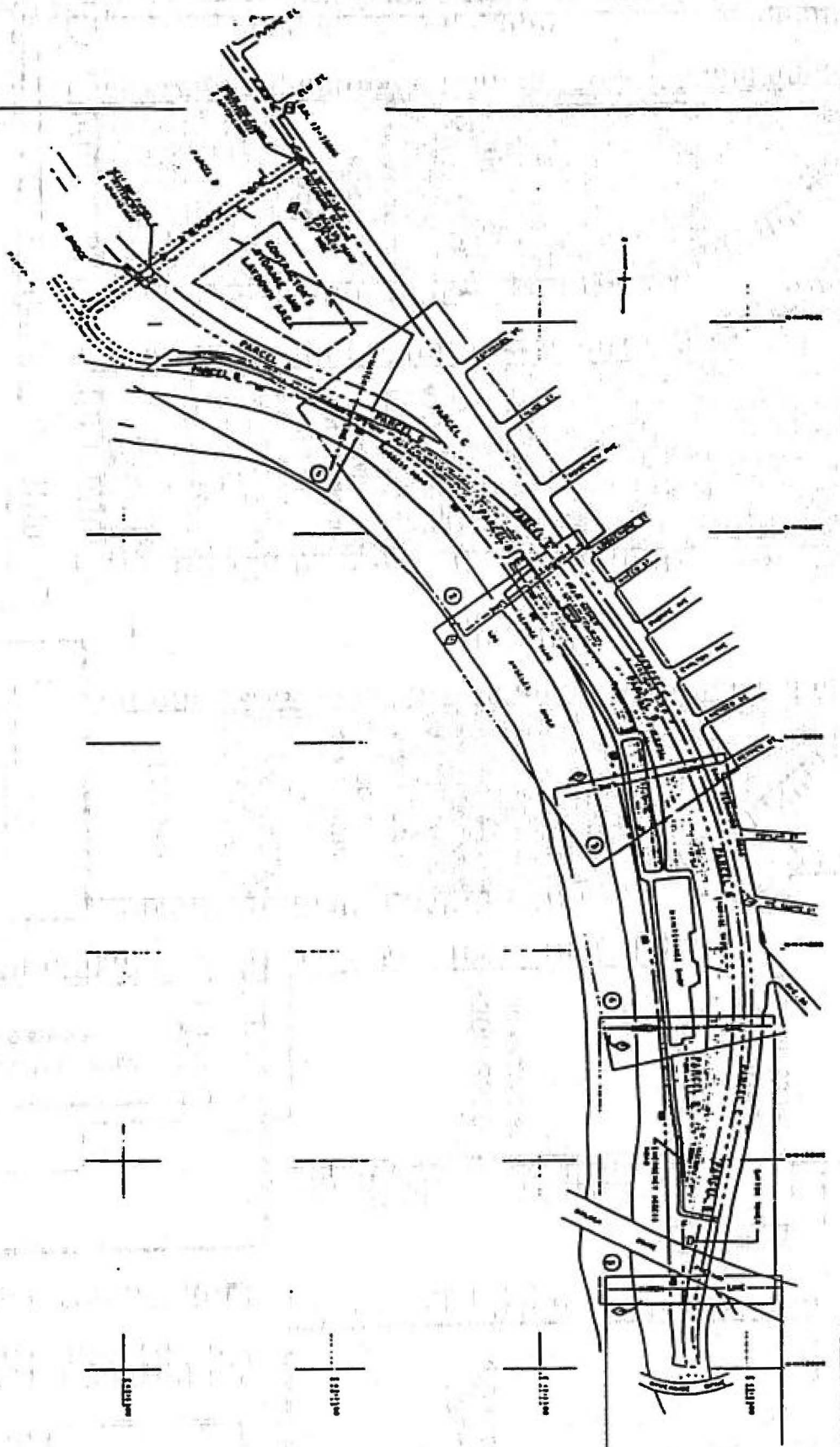

SAN FERNANDO ROAD

ACCESS

ACCESS

SS

TYBURN STREET

SS

SS

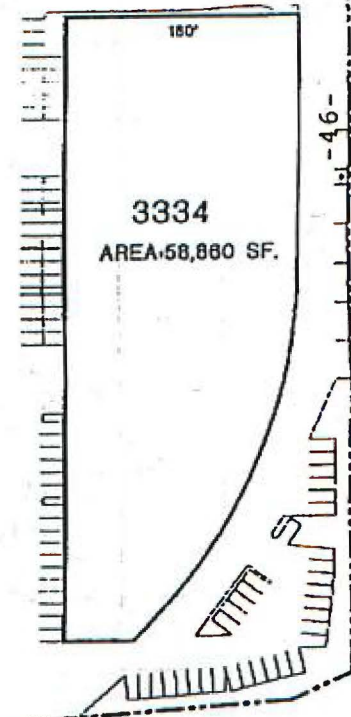
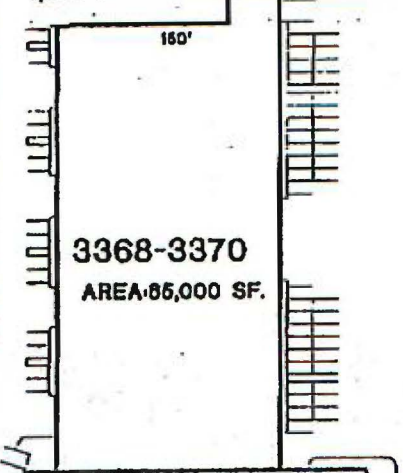
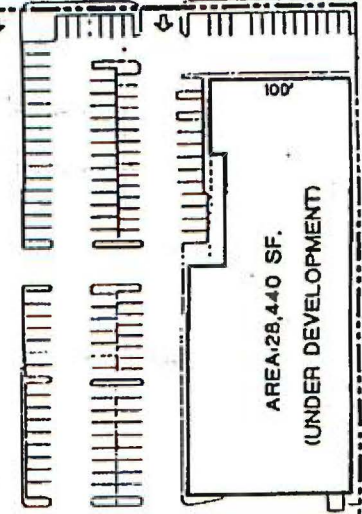
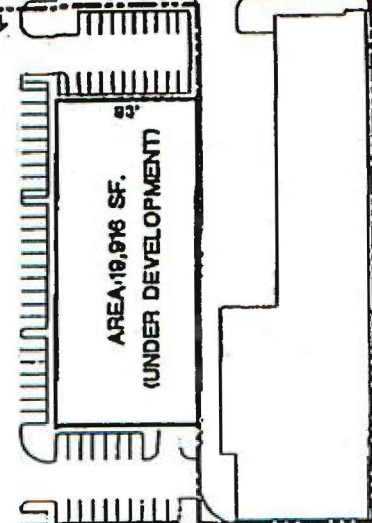
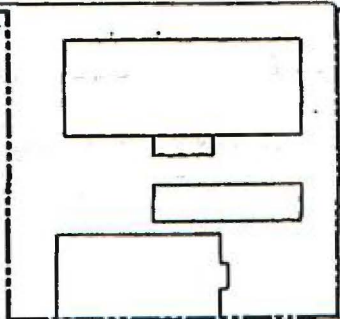
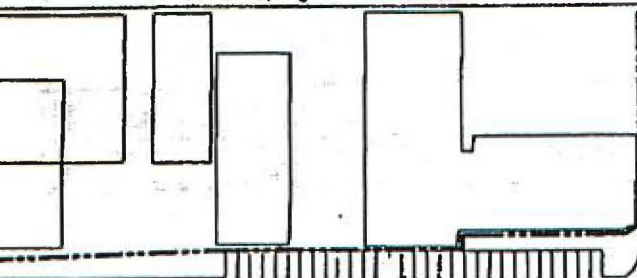

LEASED

AREA 19,976 SF.
(UNDER DEVELOPMENT)

AREA 28,440 SF.
(UNDER DEVELOPMENT)

-46-

THE GLENDALE GATEWAY CENTER

NORTH

-47-

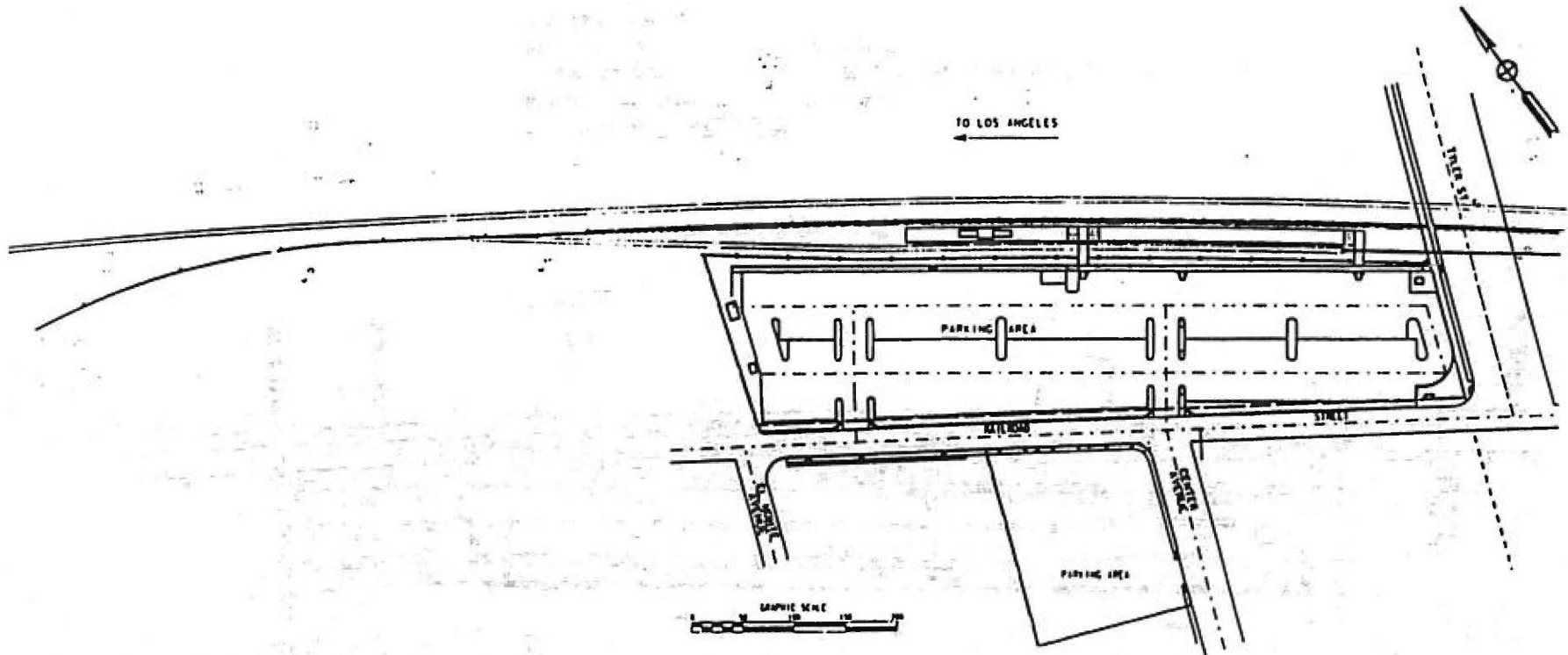

#11 - EL MONTE STATION

Major Cross Street: Tyler Ave.
 Station Address: 10925 Railroad St., El Monte, CA
 Platform Size: 14' x 425'
 # of Pkg. Spaces: 243

CONTRACT NO. C-1120 DRAWING NO. C-11 SHEET NO. 04 SCALE		COMPUTER RAIL PROJECT EL MONTE STATION SITE PLAN		SOUTHERN CALIFORNIA REGIONAL RAIL AUTHORITY DIVISION OF RAIL SERVICE AND CONSTRUCTION 100 S. GILBERT STREET PASADENA, CALIFORNIA 91101 DATE: 01-29-80 DRAWN BY: [Signature] CHECKED BY: [Signature]		11-2001 R SHEET NO. 04 DRAWING NO. C-11 SHEET NO. 04 DATE: 01-29-80	
1. TO BE CONSTRUCTION ISSUE 2. TO BE CONSTRUCTION ISSUE	DESCRIPTION						

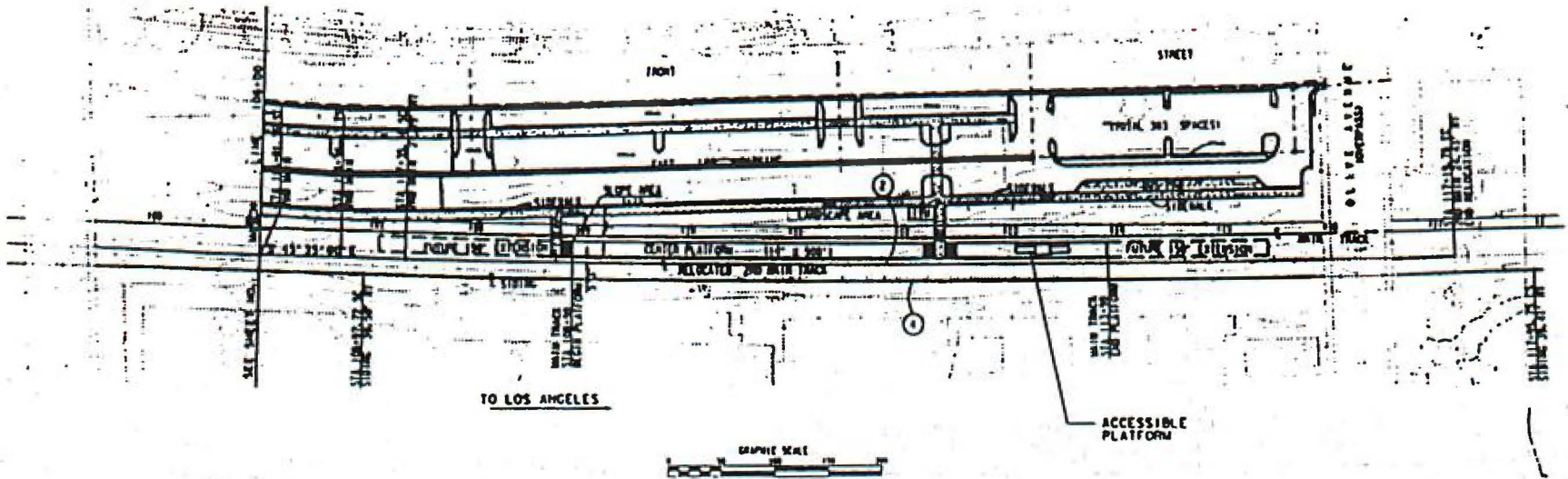

17 - BURBANK STATION

Major Cross Street: Olive Ave.
 Station Address: 201 N. Front St., Burbank, CA
 Platform Size: 14' x 500'
 # of Pkg. Spaces: 303

		SOUTHERN CALIFORNIA REGIONAL RAIL AUTHORITY COMMUTER RAIL DESIGN AND CONSTRUCTION		COMPUTER RAIL PROJECT BURBANK STATION SITE PLAN		CONTRACT NO. 1-1000 DRAWING NO. 1-3	
		DE LEONARDI & CO. 100 N. WALNUT STREET PASADENA, CALIF. 91101				PREPARED BY: [Signature] SCALE:	
DATE	DESCRIPTION	BY	APP	REVISION			

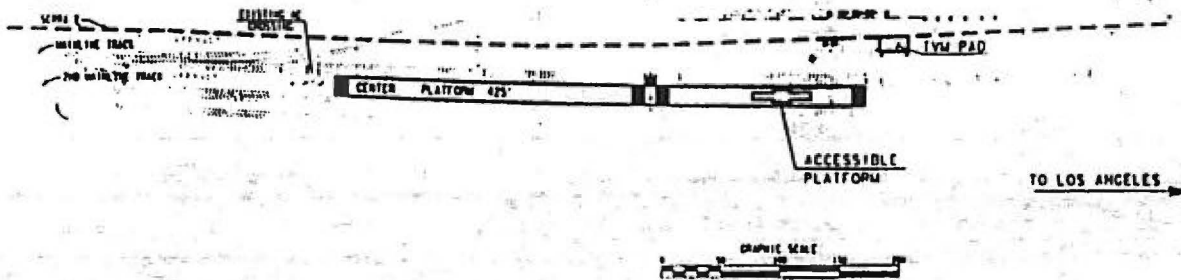

-49-

#8 - GLENDALE STATION

Major Cross Street: San Fernando Road
 Station Address: 400 W. Cerritos Ave., Glendale, CA
 Platform Size: 16' x 425'
 # of Pkg. Spaces: 313

REVISIONS NO. DATE DESCRIPTION		PROJECT NO. SHEET NO. TOTAL SHEETS	SOUTHERN CALIFORNIA REGIONAL RAIL AUTHORITY COMMUTER RAIL, DESIGN AND CONSTRUCTION DE LEVAL, CATHIER & CO. 100 N. HUNTER STREET PASADENA, CALIFORNIA 91106	COMMUTER RAIL PROJECT GLENDALE STATION SITE PLAN & RAILROAD PROFILE	DRAWN BY CHECKED BY DATE
-----------------------------------	--	--	---	---	--------------------------------

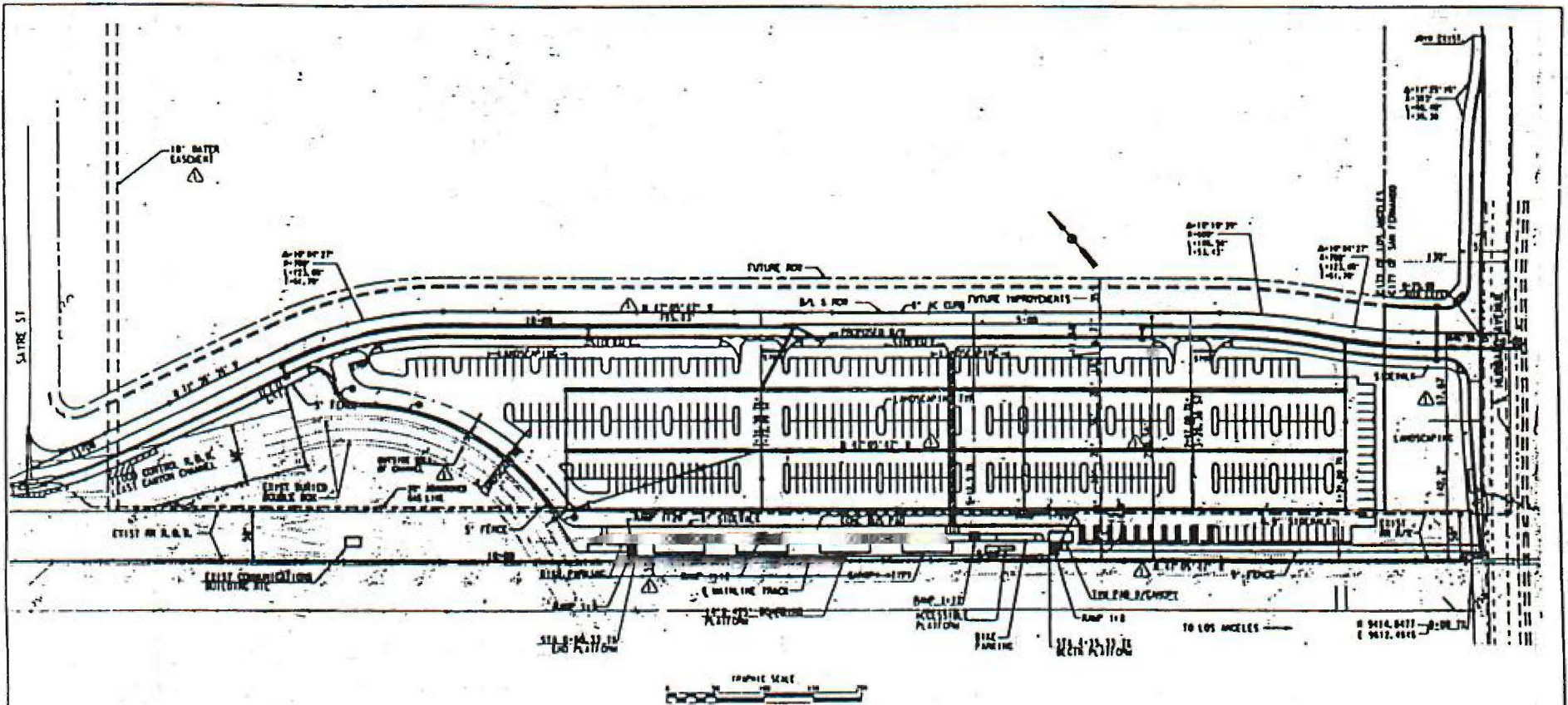

#6 - SYLMAR/SAN FERNANDO STATION

Major Cross Street: Hubbard Ave.
 Station Address: 12219 N. First St., Sylmar, CA
 Platform Size: 14' x 425'
 # of Pkg. Spaces: 403

<p>REVISIONS</p> <table border="1"> <tr> <th>NO.</th> <th>DATE</th> <th>DESCRIPTION</th> </tr> <tr> <td> </td> <td> </td> <td> </td> </tr> <tr> <td> </td> <td> </td> <td> </td> </tr> <tr> <td> </td> <td> </td> <td> </td> </tr> </table>		NO.	DATE	DESCRIPTION										<p>SOUTHERN CALIFORNIA REGIONAL RAIL AUTHORITY COMMUTER RAIL DESIGN AND CONSTRUCTION</p> <p>PARSONS BRINCKERHOFF, INC. 100 S. LAKEVIEW STREET PASADENA, CALIFORNIA 91106</p> <p>DATE: 08/11/00</p>	<p>COMMUTER RAIL PROJECT SYLMAR/SAN FERNANDO STATION SITE PLAN</p>	<p>CONTRACT NO. C-0210 DRAWING NO. SHEET NO. SCALE</p>
NO.	DATE	DESCRIPTION														

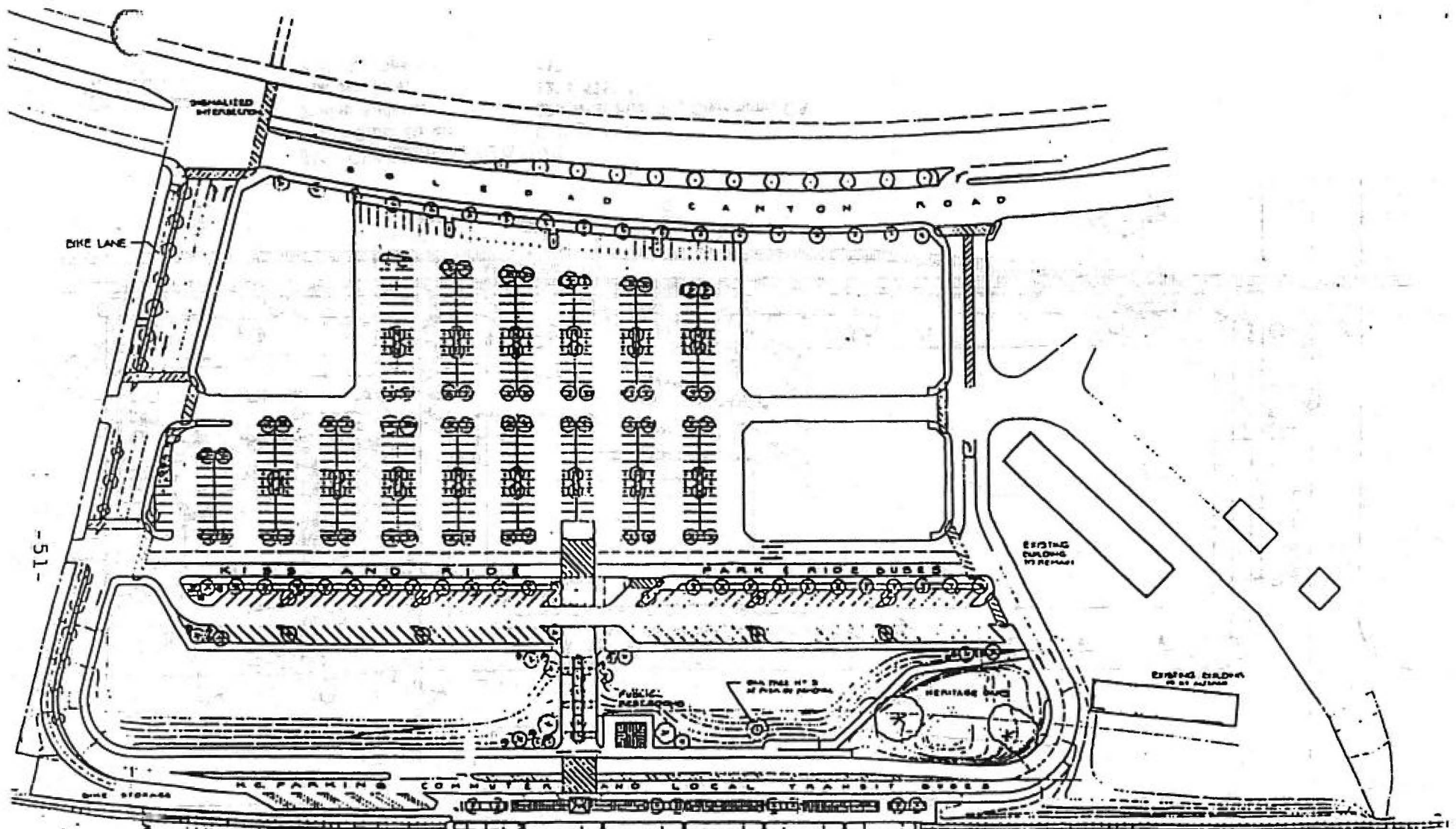

-51-

#5 - SANTA CLARITA STATION

Major Cross Street: Bouquet Canyon Road
 Station Address: 22122 Soledad Canyon Rd., Santa Clarita, CA
 Platform Size: 24' to 27' x 500'
 # of Pkg. Spaces: 492

SANTA CLARITA COMMUTER RAIL STATION

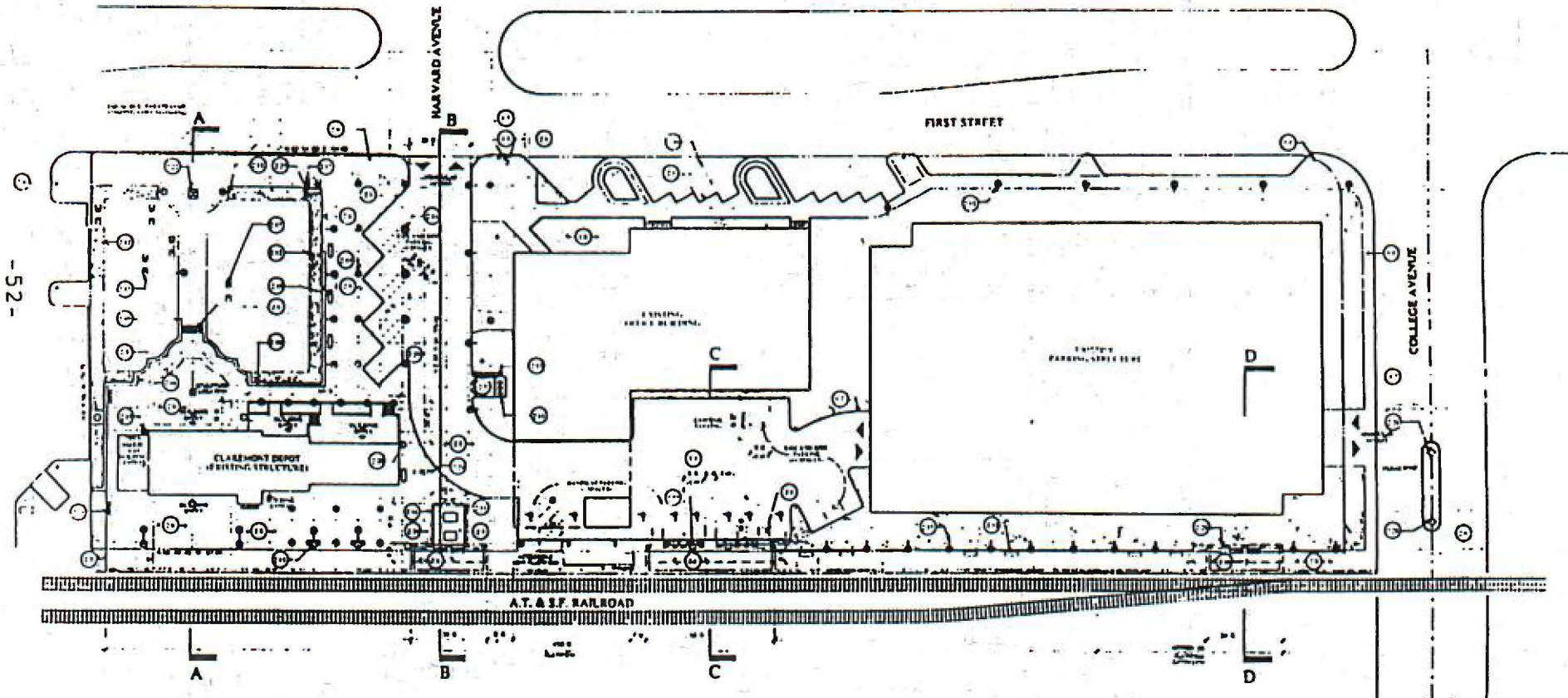

-52-

#15 - CLAREMONT STATION

Major Cross Street: College Ave.
 Station Address: 200 West First St., Claremont, CA
 Platform Size: 12' x 535'
 # of Pkg. Spaces: 417

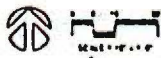

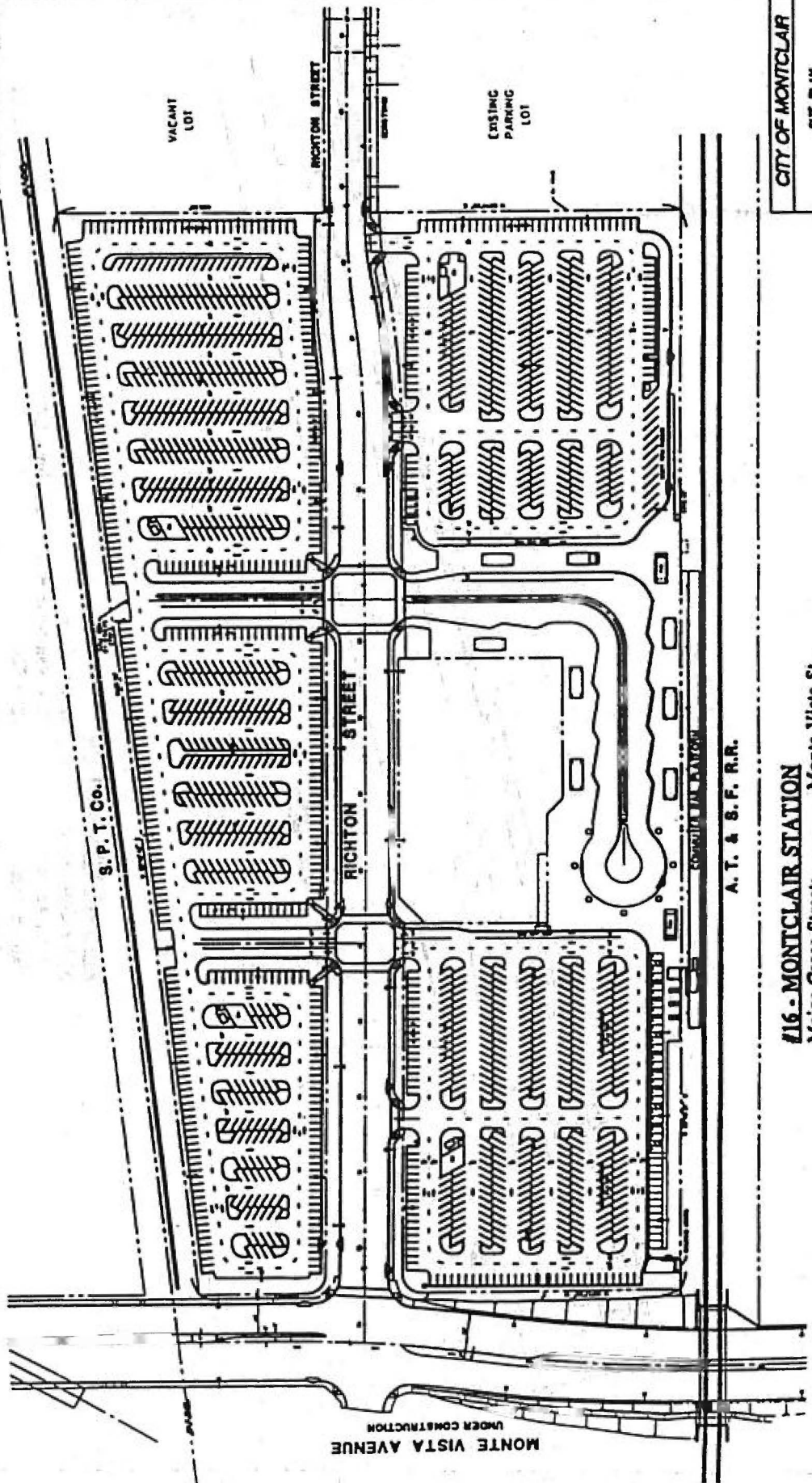

CITY OF MONTCLAIR	
SITE PLAN	
MONTCLAIR TRANSCENTER	
DATE	1961
SCALE	1" = 40'
1 OF 1	

#16 - MONTCLAIR STATION
 Monte Vista St.
 Major Cross Street: 4991 Richton St., Montclair, CA
 Station Address: 14' x 600'
 Platform Size: 1,583
 # of Pkg. Spaces:

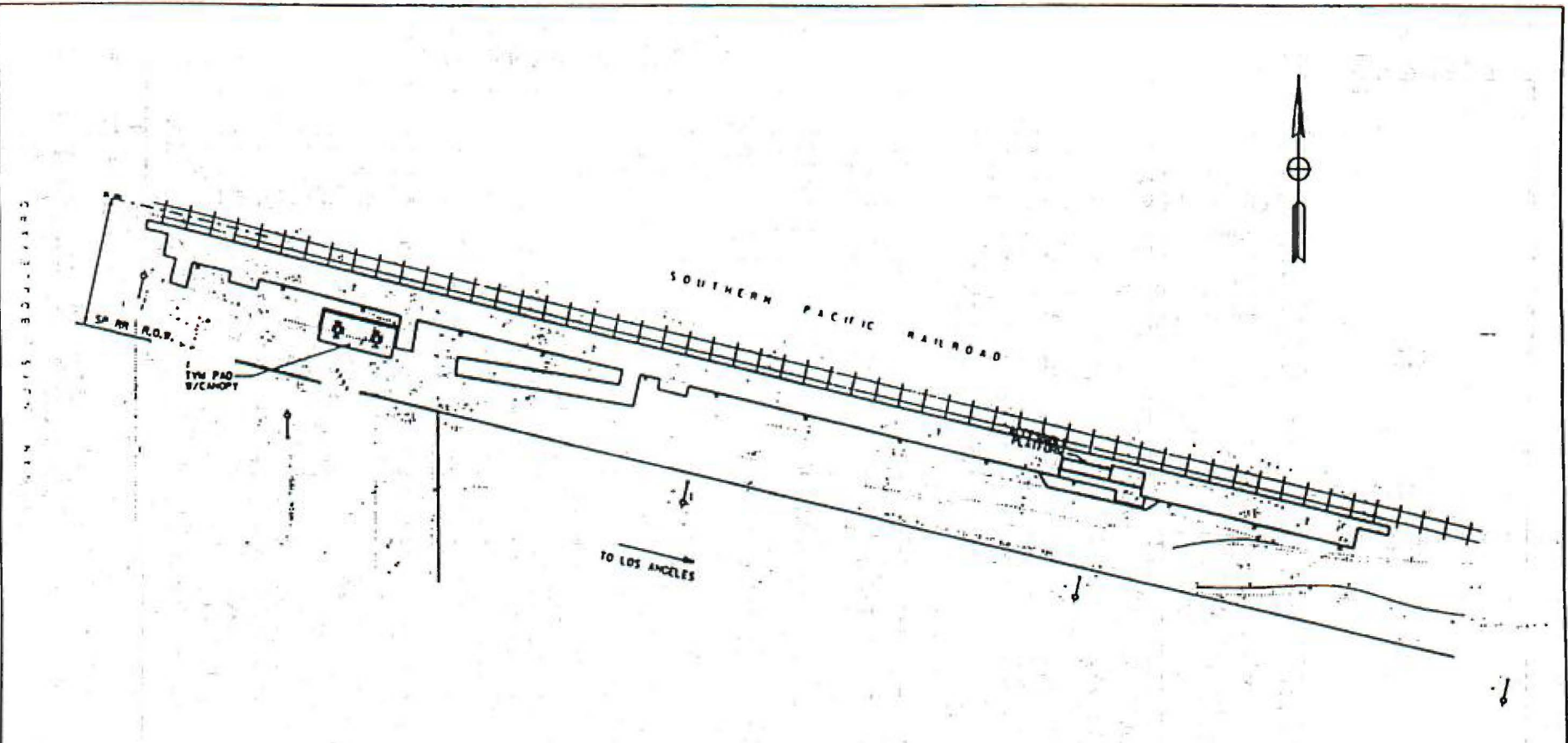

#4 - VAN NUYS STATION

Major Cross Street: Saticoy Street
 Station Address: 7720 Van Nuys Blvd., Van Nuys, CA
 Platform Size: 12' x 500'
 # of Pkg. Spaces: 85

REVISIONS NO. DATE DESCRIPTION		APPROVED BY DATE	SOUTHERN CALIFORNIA REGIONAL RAIL AUTHORITY COMPUTER RAIL DESIGN AND CONSTRUCTION PATTISON DE LUCA, INC. 100 S. DOWNEY STREET PLSBORO, CALIFORNIA 91768	COMPUTER AID DRAWING NO. PERFORMING SHEET NO. SCALE
			SUBMITTED: _____ APPROVED: _____	
			COMPUTER RAIL PROJECT VAN NUYS STATION SITE PLAN	

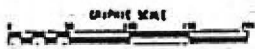
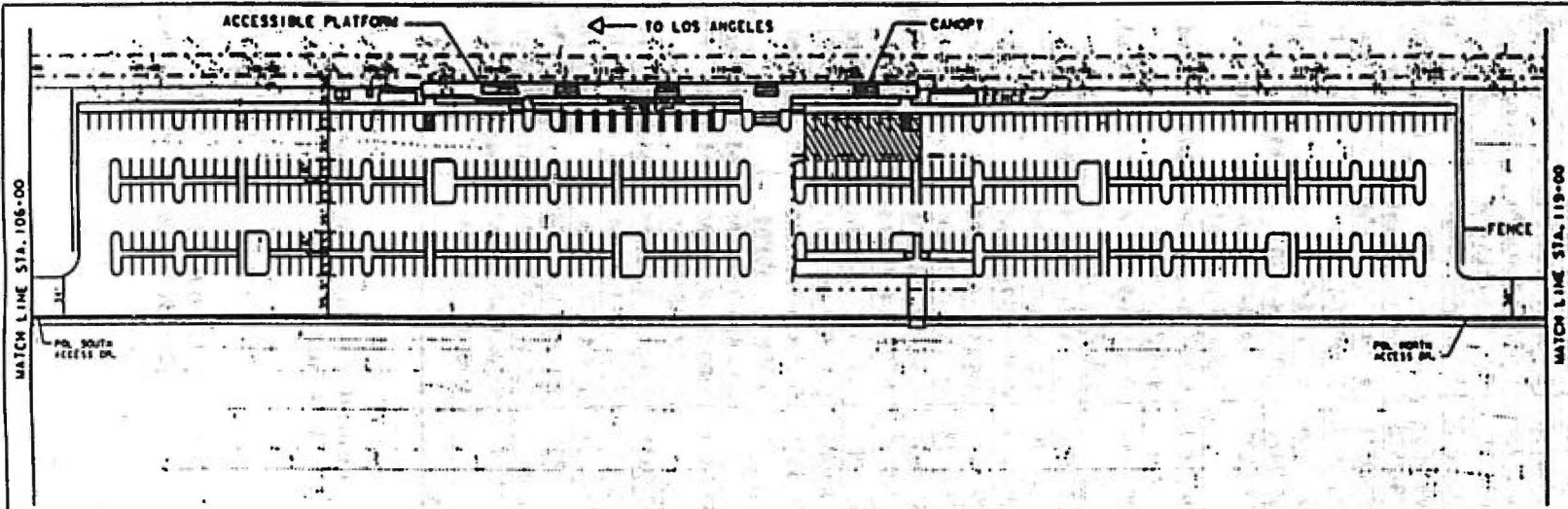

#3 - CHATSWORTH STATION

Major Cross Street: Canoga Ave.
 Station Address: 21600 Devonshire, Chatsworth, CA
 Platform Size: 12' x 425'
 # of Pkg. Spaces: 490

- 55 -

REVISIONS NO. DATE DESCRIPTION 1 10/1/00		APPROVED FOR CONSTRUCTION DATE: 10/1/00 DRAWN BY: [blank] CHECKED BY: [blank]	SOUTHERN CALIFORNIA REGIONAL RAIL AUTHORITY CHATSWORTH STATION DESIGN AND CONSTRUCTION DE SILVA, CATHERS & CO. 100 S. GARDEN STREET PASADENA, CALIF. 91106 SUBMITTED: [blank] APPROVED: [blank]	COMMUTER RAIL PROJECT CHATSWORTH STATION SITE PLAN & PROFILE	CONTROL NO. [blank] DESIGN NO. [blank] DRAWING NO. [blank] SHEET NO. [blank]
--	--	--	---	---	---

**METROLINK STATION AMBASSADORS
TELEPHONE NUMBERS AS OF 7/1/94**

STATION LOCATION	STATION AMBASSADOR	PAGER #	CELLULAR PHONE #	SCHEDULE	
				HOURS	DAYS
Oxnard	Ron Miller	(213) 963-9261	(213) 705-7365	5:00AM-7:00AM	Mon. / Wed. / Fri.
Camarillo	Ron Miller	(213) 963-9261	(213) 705-7365	5:15AM-7:15AM	Tue. / Thurs.
Moorpark	Randy Kelley	(213) 968-7850	(213) 304-6738	5:00AM-7:30AM	Tue. / Thurs.
Simi Valley	Randy Kelley	(213) 968-7850	(213) 304-6738	5:00AM-8:00AM	Mon. / Wed. / Fri.
Chatsworth	Wayne Gableton	(213) 506-6651	(213) 709-6214	5:15AM-8:15AM	Monday - Friday
Northridge	Kim Babler	(213) 968-2200	(213) 308-6613	5:15AM-8:15AM	Tue. / Thurs.
Van Nuys	Kim Babler	(213) 968-2200	(213) 308-6613	5:30AM-8:30AM	Mon. / Wed. / Fri.
Lancaster	Shirley Scales *	(213) 506-4626	(213) 308-8578	4:00AM-6:30AM	Monday - Friday
Vincent Grade / Acton	Carolyn Walters	(213) 961-3602	(213) 952-0841	4:30AM-7:00AM	Mon. / Wed. / Fri.
	Shirley Scales *	(213) 506-4626	(213) 308-8578	5:00PM-7:30PM	Tue. / Thurs.
Via Princessa	Stanley Schultz	(213) 812-0397	(213) 705-7426	5:00AM-9:30AM	Tue. / Thurs.
Santa Clarita	Stanley Schultz	(213) 812-0397	(213) 705-7426	5:00AM-9:30AM	Mon. / Wed. / Fri.
Sylmar / S.F.	Samuel Antonio	(213) 963-4702	(213) 308-9227	5:15AM-9:15AM	Tue. / Thurs.
				3:30PM-7:30PM	
Burbank	Samuel Antonio	(213) 963-4702	(213) 308-9227	5:30AM-9:30AM	Mon. / Wed. / Fri.
				3:00PM-7:00PM	
Glendale	Fethi A. Hamid	(213) 963-7881	(213) 509-3451	5:30AM-9:30AM	Mon. / Wed. / Fri.
				3:00PM-7:00PM	
San Bernardino	Abel Lujan *	(213) 961-1172	(213) 713-3549	5:00AM-7:00AM	Mon. / Wed. / Fri.
Rialto	Abel Lujan *	(213) 961-1172	(213) 713-3549	4:00AM-7:30AM	Tue. / Thurs.
Fontana	Bill Scinto	(213) 961-6564	(213) 509-2499	4:30AM-7:30AM	Tue. / Thurs.
Upland	Bill Scinto	(213) 961-6564	(213) 509-2499	4:40AM-7:40AM	Mon. / Wed. / Fri.
Montclair	Lawrence Smith	(213) 961-1240	(213) 952-0832	4:30AM-8:30AM	Mon. / Wed. / Fri.
Claremont	Lawrence Smith	(213) 961-1240	(213) 952-0832	4:30AM-8:30AM	Tue. / Thurs.
Pomona	Jed Petray	(213) 961-3240	(213) 509-2702	4:30AM-8:30AM	Mon. / Wed. / Fri.
Covina	Ronald G. Jones	(213) 961-5404	(213) 509-1905	4:30AM-8:30AM	Mon. / Wed. / Fri.
Baldwin Park	Ronald G. Jones	(213) 961-5404	(213) 509-1905	5:15AM-8:15AM	Tue. / Thurs.
El Monte	Justin Corona	(213) 961-0901	(213) 309-5518	5:15AM-9:15AM	Mon. / Wed. / Fri.
				3:30PM-7:30PM	
Oceanside	Vacant	N/A	N/A	5:00AM-7:00AM	Mon. / Wed. / Fri.
San Juan Capistrano	Fred Lamb*	(213) 991-8952	(213) 952-0837	5:00AM-8:00AM	Monday - Friday
				5:00PM-8:00PM	
Irvine	Chris Vermeer	(213) 961-3772	(213) 952-0831	5:00AM-8:00AM	Monday - Friday
	Vacant	N/A	N/A	5:00PM-8:00PM	Monday - Friday
Santa Ana	Elvin Martinez	(213) 968-3564	(213) 952-0834	5:00AM-8:00AM	Tue. / Thurs.
Orange	Carlos Medina	(213) 961-2062	(213) 952-0836	5:15AM-8:15AM	Tue. / Thurs.
Anaheim	Elvin Martinez	(213) 968-3564	(213) 952-0834	5:30AM-8:30AM	Mon. / Wed. / Fri.
Fullerton	Carmen Armienta	(213) 991-8449	(213) 705-7192	5:30AM-8:30AM	Monday - Friday
				4:30PM-7:30PM	
Commerce	Vacant	N/A	N/A	N/A	N/A

• LINE SUPERVISORS

NOTE - Line Supervisor for Ventura County and Sylmar/San Fernando station is Sam McLawyer.
Pager: (213)506-7943 Cellular Phone: (213)509-4063 Office:(213)244-7018

Effective July 1st, to communicate train delays please contact:

- from 4:00AM-8:30 AM effected Line Supervisor.

-from 8:30AM-2:00PM Jaqueline Cosby at LAUPT.

-from 2:00PM-9:00PM Rebecca Thompson at LAUPT.

Pager

Cellular Phone

(213) 991-1850

(213) 308-6782

(213) 968-7900

(213) 309-8182

STATION LOCATION	STATION AMBASSADOR	PAGER #	CELLULAR PHONE #	SCHEDULE	
				HOURS	DAYS
Riverside	Madeleine Mulkern	(213) 963-4957	(213) 509-3793	4:45AM-7:45AM	Monday - Friday
				2:30PM-3:30PM	Friday
Pedley	Milton Porter*	(213) 963-4957	(213) 509-3793	4:50AM-7:50AM	Tue. / Thurs.
East Ontario	Milton Porter*	(213) 963-8139	(213) 309-8146	5:00AM-8:00AM	Mon. / Wed. / Fri.
Industry	Stuart Yocum	(213) 963-8363	(213) 309-6648	5:15AM-8:15AM	Tue. / Thurs.
Los Angeles	Jacqueline Cosby *	(213) 991-1850	(213) 308-6782	6:00AM-3:00PM	Monday - Friday
Union Station	Rebecca Thompson*	(213) 968-7900	(213) 309-8182	2:00PM-9:00PM	Monday - Friday
Info. Center	Renita Reeves	(213) 991-3403	N/A	7:00AM-4:00PM	Monday - Friday
6:30AM -	Mariza Zelada	N/A	N/A	3:00PM-7:00PM	Monday - Friday
6:30PM	Angela Vietenhans	N/A	N/A	3:00PM-9:00PM	Monday - Friday
(213) 626-7259	James Jackson	N/A	N/A	6:00AM - 10:30AM	Monday - Friday
MCI Center Kiosk	Mariza Zelada	N/A	N/A	11:00AM - 2:00PM	Monday - Friday

• LINE SUPERVISORS

NOTE - Line Supervisor for Ventura County and Sylmar/San Fernando station is Sam McLawyer.

Pager: (213)506-7943 Cellular Phone: (213)509-4063 Office:(213)244-7018

Effective July 1st, to communicate train delays please contact:

- from 4:00AM-8:30 AM effected Line Supervisor.

-from 8:30AM-2:00PM Jaqueline Cosby at LAUPT.

-from 2:00PM-9:00PM Rebecca Thompson at LAUPT.

Pager

Cellular Phone

(213) 991-1850

(213) 308-6782

(213) 968-7900

(213) 309-8182

METROLINK QUICK REFERENCE TELEPHONE NUMBERS

	NAME	CELL. PHONE	PAGER	OFFICE
Media	Peter Hidalgo	(213) 910-3717	(213) 812-2762	(213) 244-6142
Ambassadors / CTS	Sheryl Carrerow		(213) 963-5157	(213) 244-6813
Passenger Counts	Karen Watanabe-Sakoda			(213) 244-6298
Stations	Stuart Chuck		(213) 812-3162	(213) 244-6312
TVM Problems	John Schwamb		(213) 812-2753	(213) 244-6589
TVM Repair	ASCOM			(213) 258-0268
Communications Coordinator/CCF	Lorinda McClure	Morning Shift 5:00AM-1:00PM		(213)259-9368
	Frank Chavez	Evening Shift 1:00PM-10:00PM		
Communications Equip.	Nancy Warner		(213) 961-9161	(213) 244-7087
Corp. Pass Prog.	Rhonda Daley		(213) 968-7411	(213) 244-6585
Distribution Ambassador	Sam McLawyer*	(213)509-4063	(213) 506-7943	(213) 244-7018
Administrative Analyst	Jessica Blue			(213) 244-7209
Amtrak Passenger LAUPT Services & Ticket Office	6:30 a.m. - 9:30 a.m., 10:00 a.m. - 1:30 p.m. 3:00AM - 6:00PM (For Ambassador use only.)			(213) 683-6917
LAUPT Metrolink Information Center	HOURS: 6:30AM-6:30PM (For Ambassador use only)		FAX #: (213) 626-4943	(213) 626-7259
Lost and Found Procedures: 1) Valuable items left on train 2) Non-essential items left on train	Contact the Communications Coordinator. Contact Metrolink Information Center. (Lost and found phone numbers are for internal use only. DO NOT PROVIDE TO PASSENGERS!)			(213) 259-9368 (213) 626-7259
Signal Problems	On Duty Officer			(800) 404-9464 (213) 340-8300
Insurance Claims	Ron Phares			(818) 957-7117
Non-emergency situations	Metrolink Sheriff			(818) 248-3464 Ask for Metrolink Dispatcher
Southern California Regional Rail Authority (SCRRRA)		P.O. Box 194 Los Angeles, CA 90053		
EMERGENCY PROCEDURE :	1st - PHONE 911 FROM PAYPHONE OR DIAL YOUR LOCAL POLICE DEPARTMENT DIRECT, USING THE LIST PROVIDED TO YOU. 2nd - ALWAYS MAKE IMMEDIATE FOLLOW-UP CALL TO METROLINK SHERIFFS. 3rd - FOR SECURITY INCIDENTS ON BOARD, PHONE SHERIFF'S DISPATCH DIRECT.			

*Line Supervisor for Ventura County line and Sylmar/San Fernando station.

Effective July 1st, to communicate train delays please contact:

-from 4:00AM-8:30AM effected Line Supervisor.

-from 8:30AM-2:00PM Jaqueline Cosby at LAUPT.

-from 2:00PM-9:00pm Rebecca Thompson at LAUPT.

Pager

Cellular Phone

(213) 991-1850

(213) 308-6782

(213) 968-7900

(213) 309-8182

CHATSWORTH WORK STOPPAGE SERVICE

	(SNB-1) 901	(RVS-2) 903	(SNB-3) 907
LOS ANGELES	7:00A	8:10A	3:36P
GLENDALE	7:13	8:23	3:48
BURBANK	7:24	8:34	3:55
VAN NUYS	7:34	* 8:44	4:05
NORTHRIDGE	7:41	8:51	4:12
CHATSWORTH	8:05	8:59	4:20

	X902	X904	900
CHATSWORTH	8:14A	9:10A	4:30P
NORTHRIDGE	8:20	9:16	4:36
VAN NUYS	8:27	9:23	* 4:43
BURBANK	8:37	9:33	4:53
GLENDALE	8:44	9:40	5:00
LOS ANGELES	8:58	9:54	5:15

* Indicates no wheel chair ramp available at this stop.
(Train will stop on track #1.)

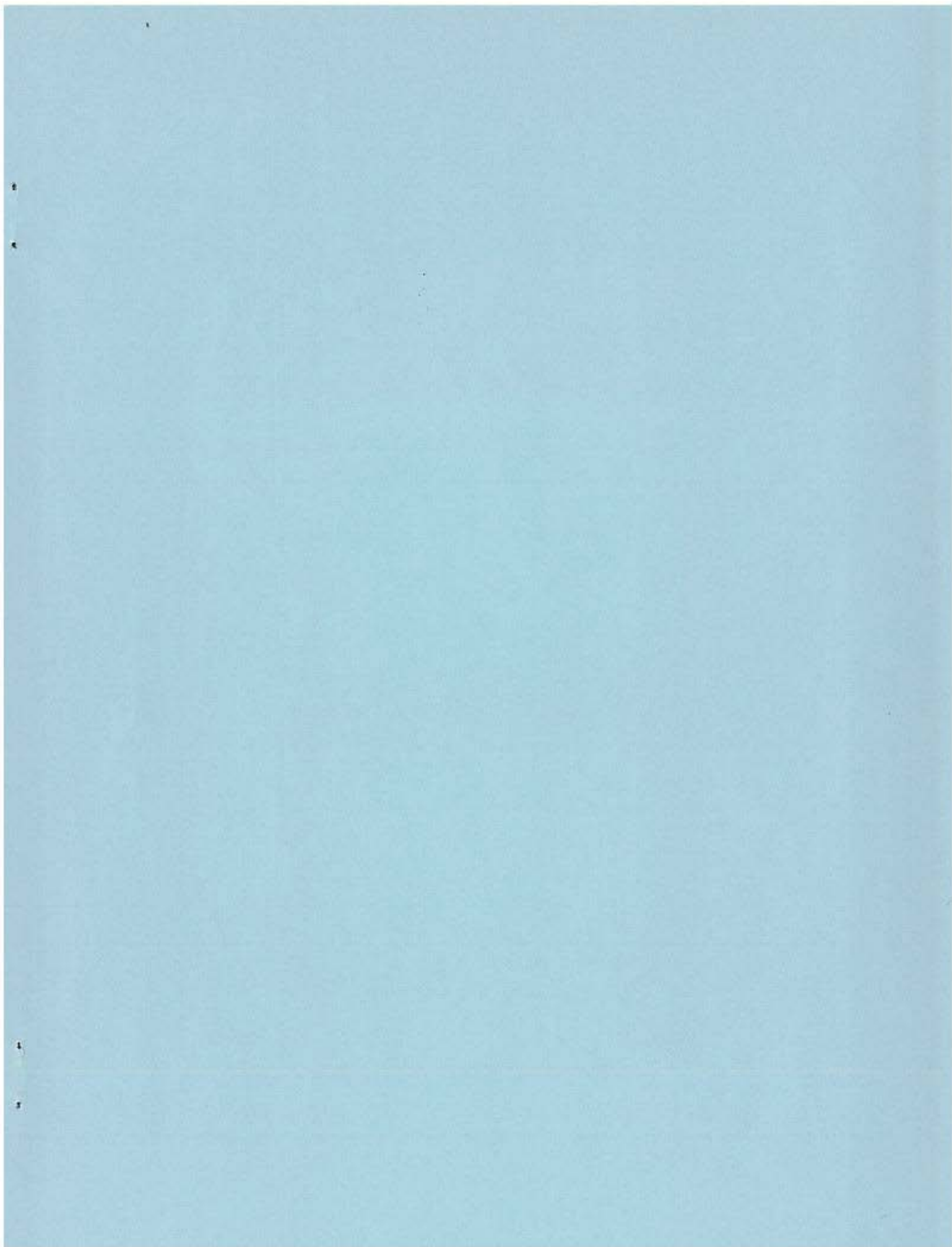

HTA DOROTHY GRAY LIBRARY & ARCHIVE
Emergency contingency plan in case of w
HD5306.L6 E97



100000147049